

GFW-KEY-Z2000

ADJUSTABLE Z-STYLE KEYBOARD STAND WITH 2ND TIER

ASSEMBLY INSTRUCTIONS

GATOR FRAMEWORKS

GENERAL INTRODUCTION:

The Frameworks GFW-KEY-Z2000 Adjustable Z-Style Keyboard Stand with 2nd Tier is the ultimate 2-tier solution for musicians seeking a versatile and robust setup. This stand features height adjustability from 24" to 38" (61 - 96.5 cm), accommodating both seated and standing playing positions for maximum comfort. Its width adjusts from 20" to 35" (50.8 - 88.9 cm), making it compatible with most keyboards wider than 20" (50.8 cm). The second tier adds another layer of functionality, with a height adjustable from 7" to 12" (17.8 - 30.5 cm) above the lower tier, perfect for stacking multiple keyboards or other gear. EVA foam padding on all contact surfaces ensures your instruments are protected from scratches and stay securely in place. Constructed from black powder-coated square aluminum tubing, this stand is as durable as it is sleek, with the first tier supporting up to 375 lb (170 kg) and the second tier up to 60 lb (27.2 kg). Whether you're performing live or setting up in the studio, the GFW-KEY-Z2000 delivers reliable stability and customizable versatility to meet your needs.

ASSEMBLY INSTRUCTIONS:

1

Remove the female Knobs from the Bracket and Leg assembly.

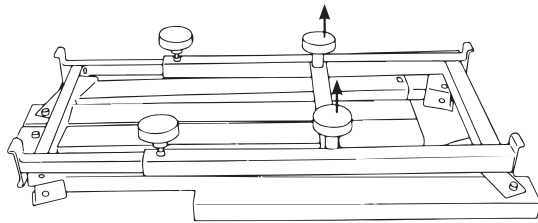

2

Lift the Bracket off the Legs to detach.

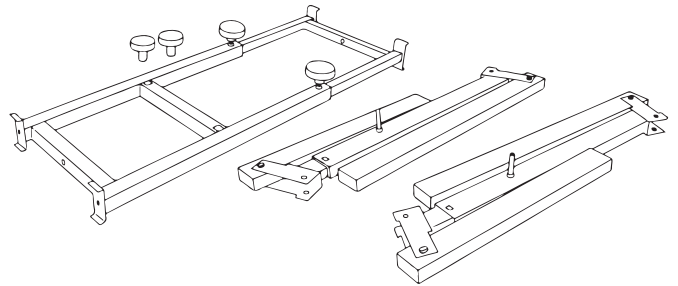

3

Unfold the Legs until they click into a Z position. Then attach the Bracket to the Legs, one Leg at a time, and tighten in place with the Knobs that were removed in step 1.

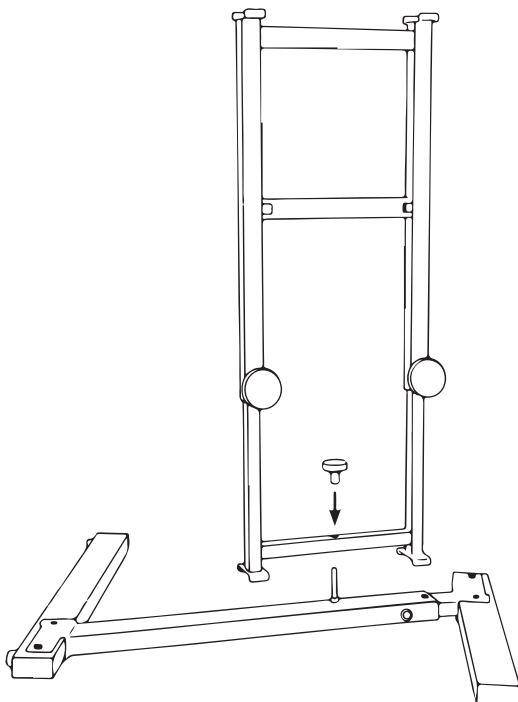

4

Once you have attached the Bracket and Legs, position the Stand so that it is standing up.

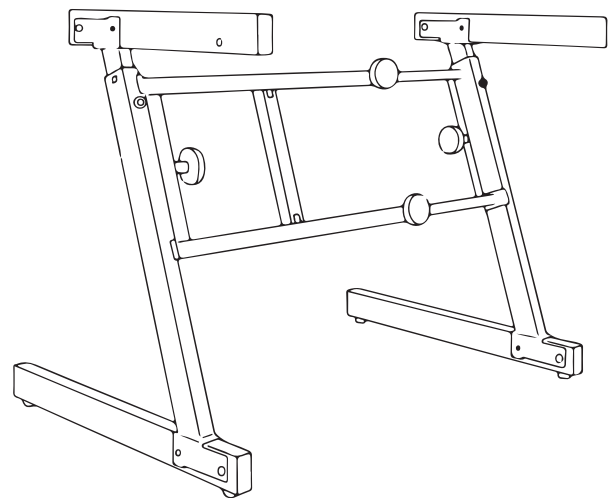

ASSEMBLY INSTRUCTIONS:

5

Insert the M10 X 20 knobs into the Welded Nuts on the Brackets.

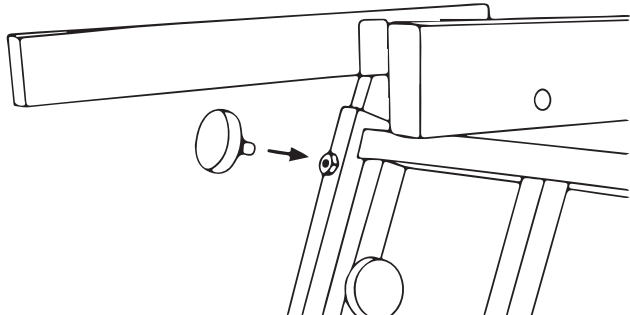

6

Use those Knobs to adjust the height of the Stand to your liking.

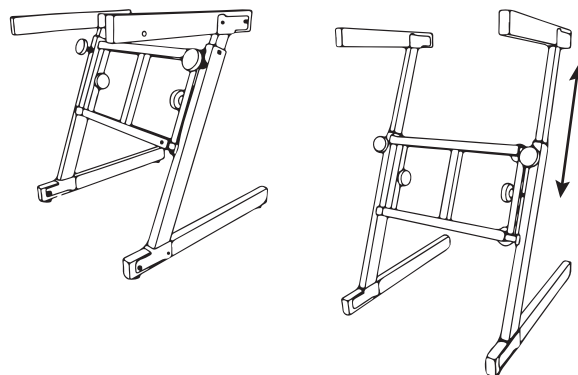

7

Unfold the Second Tier Arms.

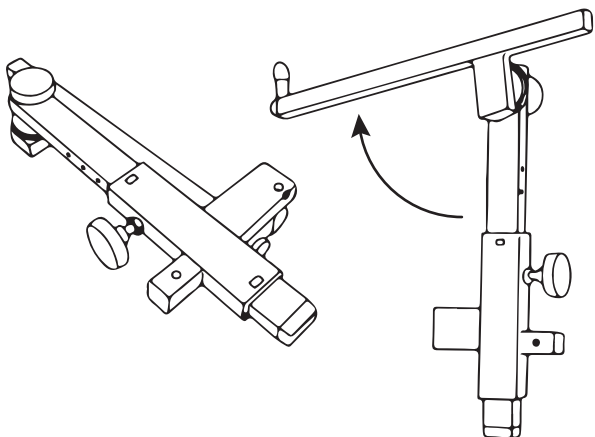

8

Remove the Knob from the Second Tier Arm and insert Arm into the stand. Repeat step for the remaining Arm.

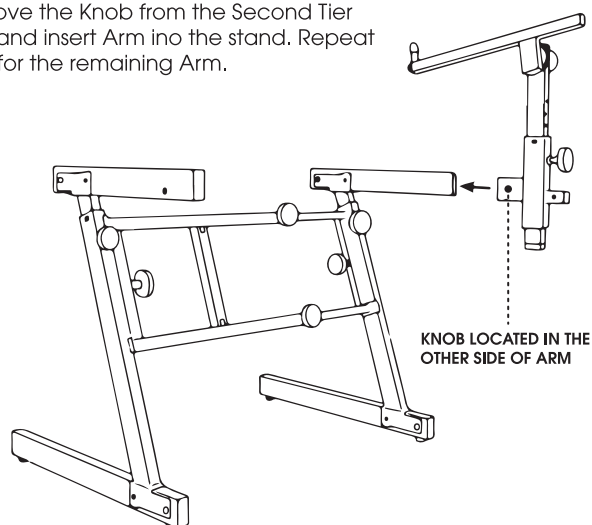

9

Remove the two Knobs at the ends of the Support Bar.

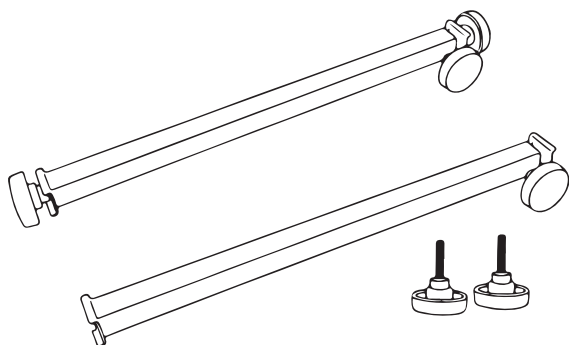

10

Attach the Support Bar to the Back of Second Tier Arms using the two Knobs removed in step 9. Ensure all Knobs are tightened.

