

# RI-SPK-SM20-TRI

## STUDIO MONITOR STAND (PAIR)

### ASSEMBLY INSTRUCTIONS

**GATOR FRAMEWORKS**

#### GENERAL INTRODUCTION:

The Rok-It RI-SPK-SM20-TRI Studio Monitor Stands are the perfect blend of durability and stability, designed to enhance your audio production needs. Crafted from heavy-duty steel, these stands provide a rock-solid foundation for your studio monitors, ensuring they stay securely in place. The 18" triangular base maximizes stability, giving you peace of mind even during intense sessions. The 9.5" speaker platform easily accommodates most studio monitors, while the rubberized surface minimizes unwanted noise and prevents slippage, ensuring your sound is as clean as possible. For added safety, the stands are equipped with a locking pin that securely prevents any accidental collapse while in use. Whether your setup is on carpet or hard floors, the included carpet leveling spikes ensure a balanced and stable setup, making the Rok-It RI-SPK-SM20-TRI Studio Monitor Stands a reliable choice for any audio professional.

#### COMPONENTS:

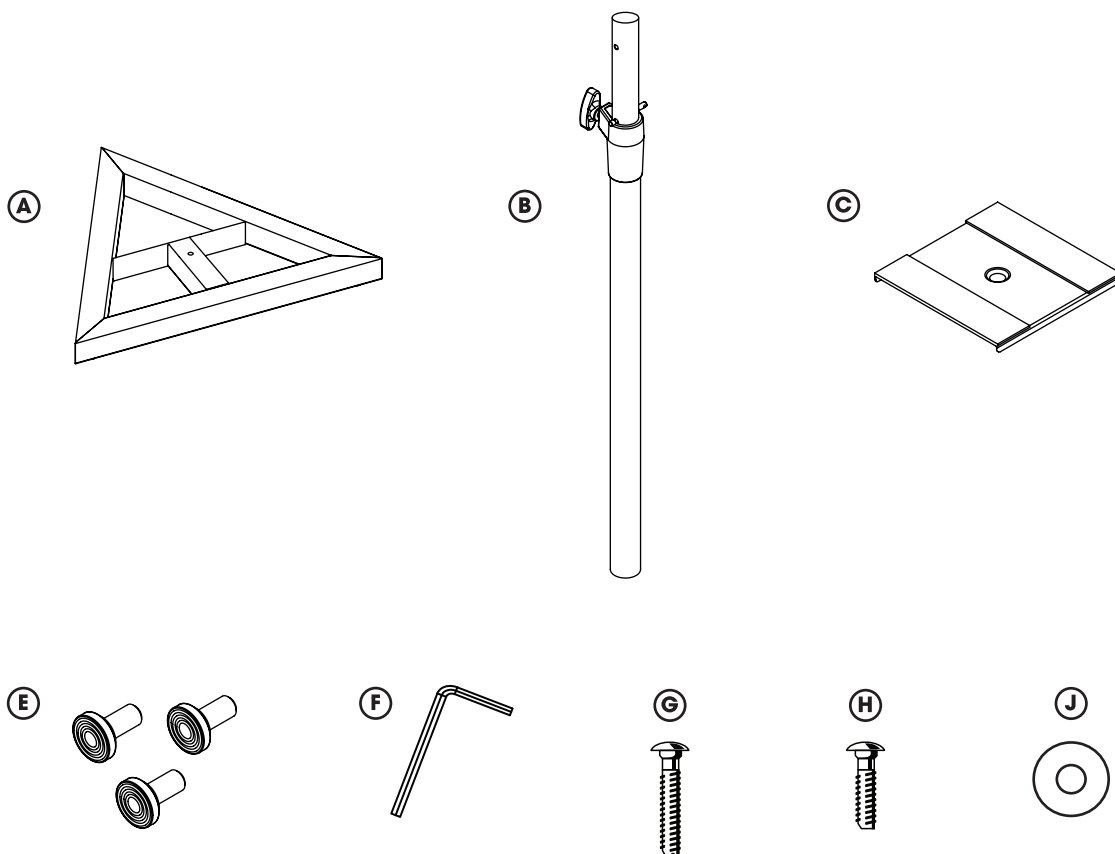

## ASSEMBLY INSTRUCTIONS:

1

Insert stand feet **(E)** into the three holes on the bottom of stand base **(A)**. Then attach the support pole **(B)** to the stand base using the hex wrench **(F)** to screw the washer **(J)** and long screw **(G)** to base.

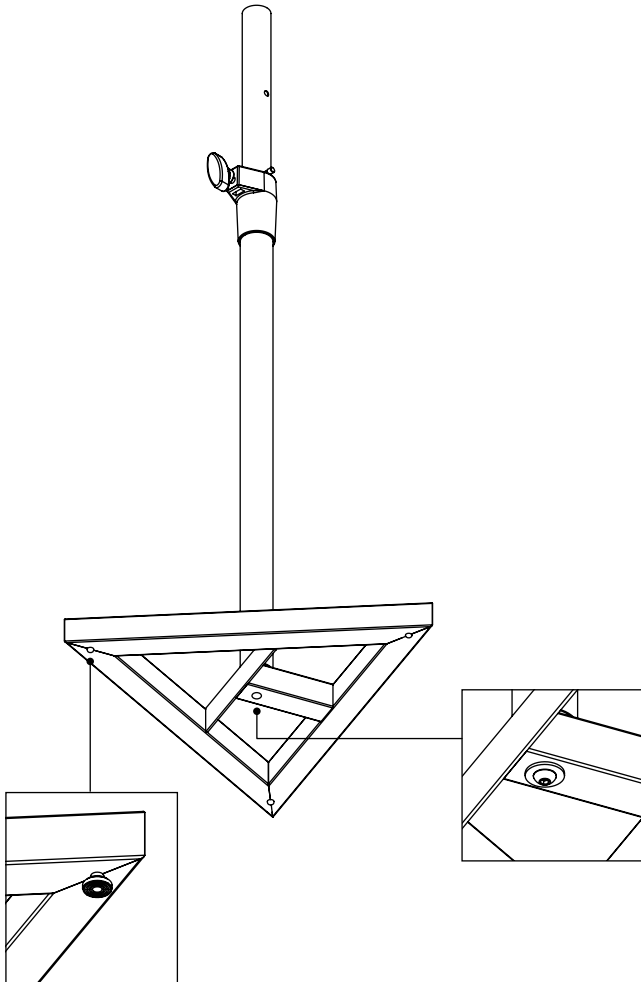

2

Screw the speaker platform **(C)** onto the adjustment pole with the short screw **(H)**.

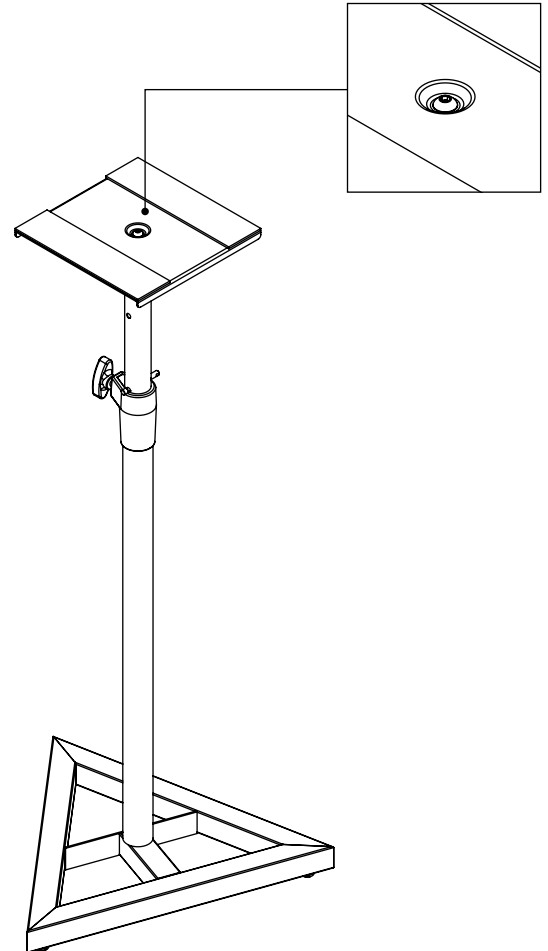

## FEATURES:

// HEAVY-DUTY STEEL CONSTRUCTION

// 18" (45.7CM) SPEAKER PLATFORM EASILY ACCOMMODATES MOST STUDIO MONITORS

// RUBBERIZED PLATFORM SURFACE PREVENTS UNWANTED NOISE & SLIPPAGE

// LOCKING PIN SECURELY PREVENTS STAND FROM COLLAPSING WHILE IN USE

// INCLUDES (6) CARPET LEVELING SPIKES