

GFW-ELITEDESK

ELITE WORKSTATION DESK

ASSEMBLY INSTRUCTIONS

GATOR FRAMEWORKS



THIS PRODUCT COMES AS THREE (3) PACKAGES.

Top & Keyboard Tray: (1 of 3)

Dimensions: 48.5"/123cm x 31"/79cm x 2.5"/6.5cm

Weight: 53lbs/24kg

2nd Tier & Rack Rails: (2 of 3)

Dimensions: 48.5"/123cm x 15"/38cm x 3.75"/9.5cm

Weight: 40lbs/18kg

Legs & Cable Management: (3 of 3)

Dimensions: 29.5"/75cm x 8"/20cm x 8"/20cm

Weight: 22lbs/10kg

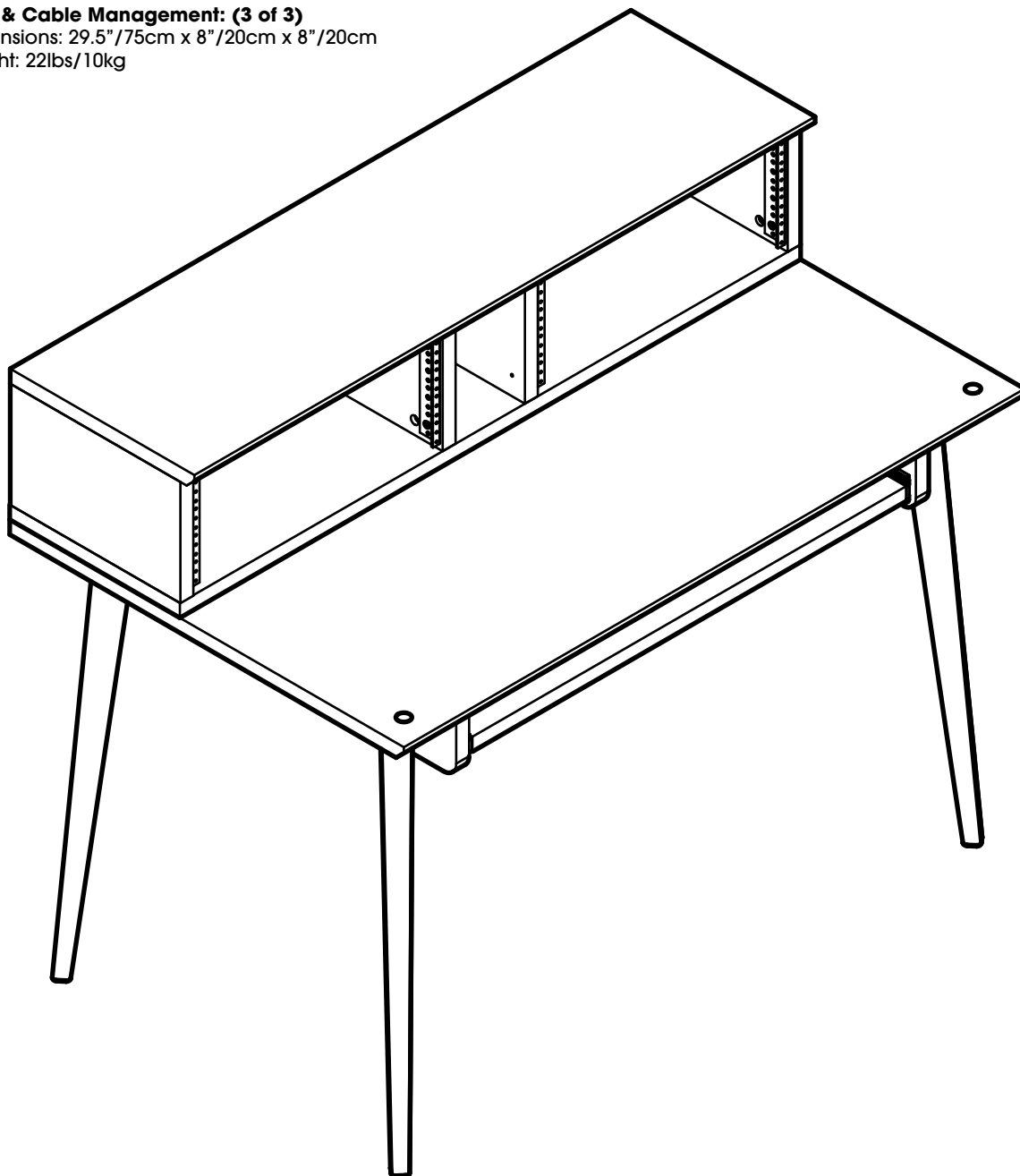

Workstation: **350lbs (evenly distributed)**

Top: **200lbs**

2nd Tier & 4U Rack Gear: **100lbs**

Keyboard Tray: **50lbs**

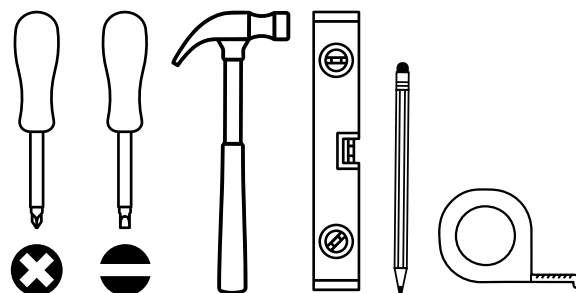

5112 W. Linebaugh Ave. • Tampa, FL • Phone: (+1) 813.221.4191 • Fax (+1) 813.221.4181

©2021 Gator Co. • Visit www.gatorframeworks.com for more service & product information • All rights reserved

CAUTION

FAILURE TO FOLLOW THESE WARNINGS OR ASSEMBLY INSTRUCTIONS, MAY RESULT IN PROPERTY DAMAGE, SERIOUS BODILY INJURY OR DEATH.

- This unit contains small parts and packaging which could be a choking hazard for small children. Children should always be under adult supervision.
- Always unload unit and unplug all cables prior to moving the unit. The weight of personal belongings, or a snagged cable could cause the unit to become unstable and either tip or collapse.
- Do not slide the unit across the floor, as this may cause leg failure and the workstation could collapse.
- Do not overload any surface of the unit. The top or shelves could collapse. (See cover page for max weight load)
- Second (2nd) tier shelf must be secured to the workstation top with the provided bracket and hardware.
- Do not climb, step, or excessively lean on the unit. The unit may become unstable and either tip or collapse.
- Do not attach or overload the sides, rear, or front of the unit, unless specified as an accessory, as this can create a force which can cause the unit to tip.
- After mounting the cam posts and dowels to the panels, be careful to not hit the cam posts and dowels prior to final assembly as damage and misalignment can occur to the mounting of the parts. This may cause the unit to not assemble correctly and create an unstable unit.
- Use hand tools for assembly to prevent damage like stripping or overtightening hardware.
- You may use a power drill to pre-drill holes for attaching cable management and brackets. Be sure to follow proper safety procedures when using power tools.
- We recommend you protect your work surface during assembly to prevent scratching or damage to tabletops, wood floors, etc.
- Legs have a removable inner panel which allows for routing cables down the legs. All cables must be disconnected before moving equipment, or unit could become unstable and either tip or collapse.
- It is recommended to have assistance when assembly steps require flipping unit over, stacking second (2nd) tier, or units require moving into place.
- Exercise caution if you see this (symbol)  in the instruction guide.
- Wipe clean with a cloth dampened in a mild cleaner, then wipe dry with a clean cloth.



CONFIGURATIONS

FOLLOW THESE STEPS FOR THE DESIRED RACK CONFIGURATION

i

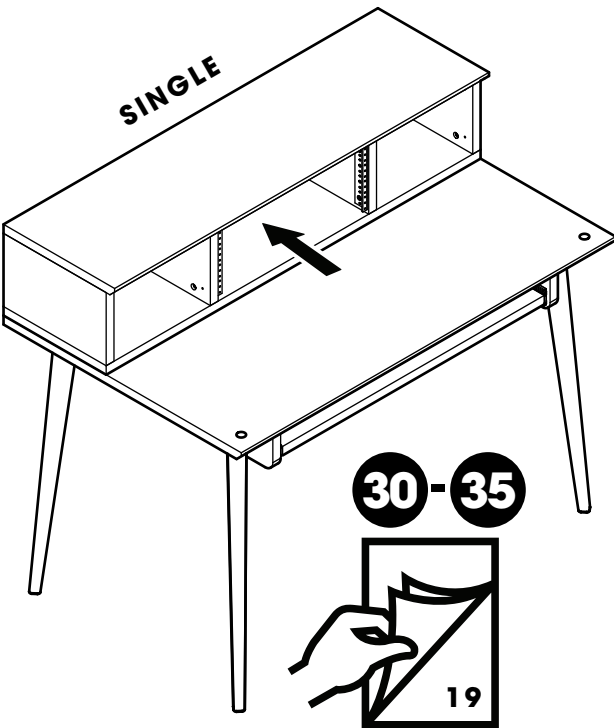
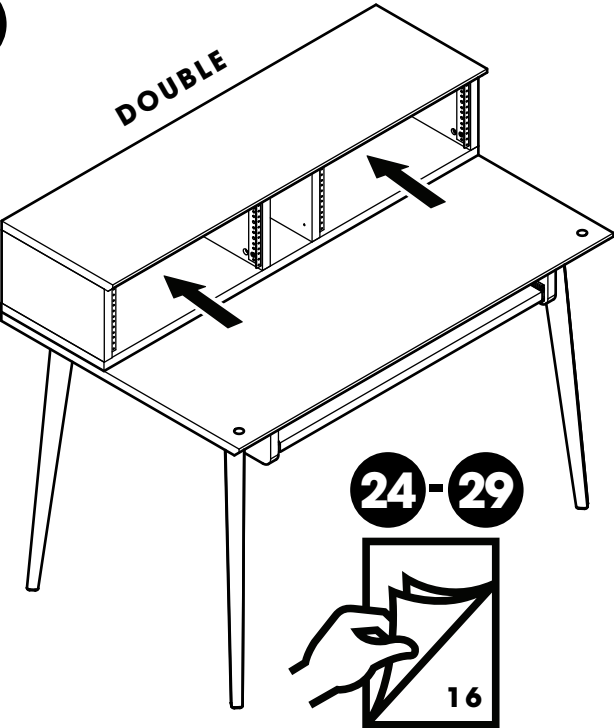

HARDWARE

VERIFY YOU HAVE ALL NECESSARY HARDWARE. WE EVEN SENT YOU EXTRA.

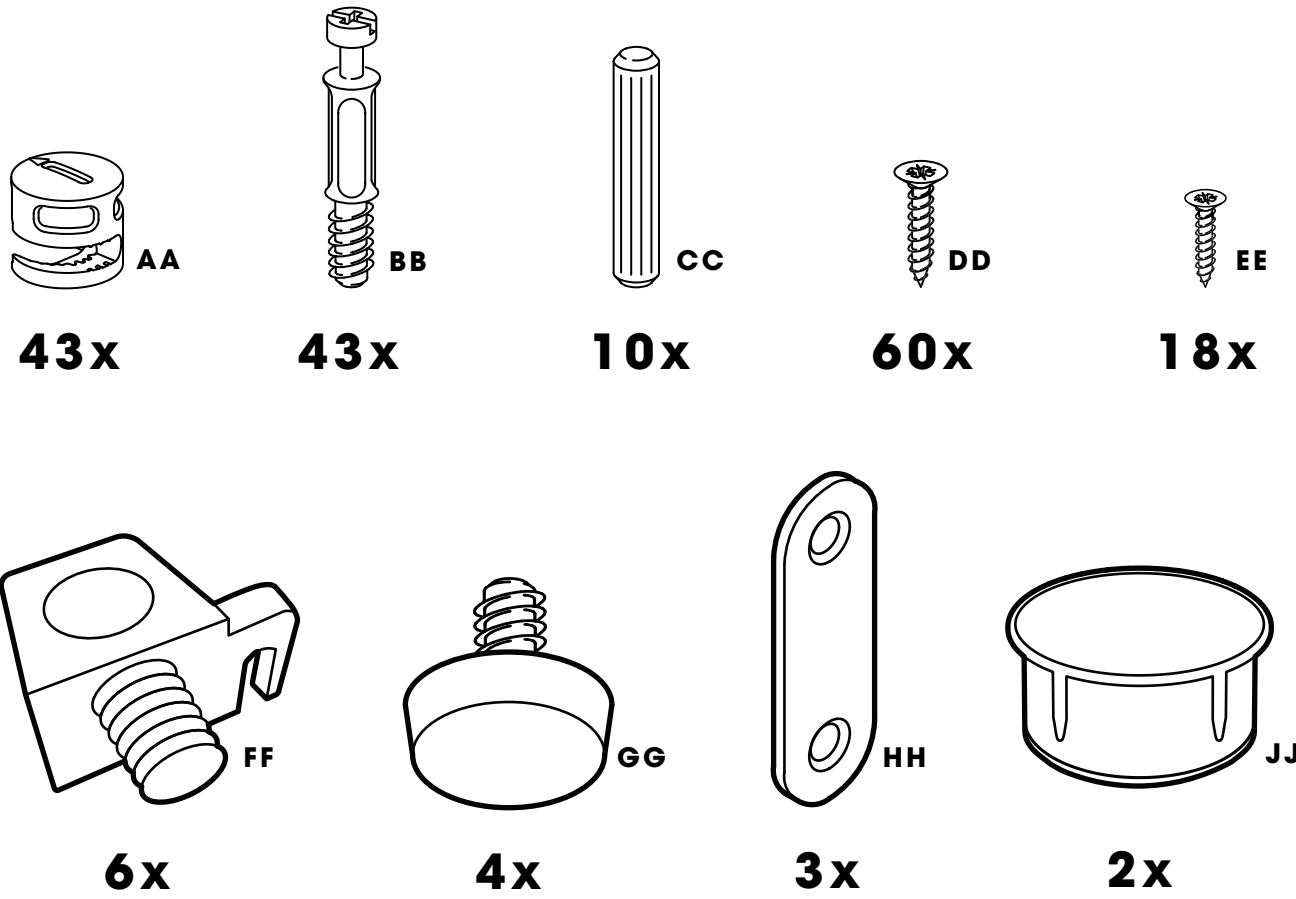

PARTS

PARTS COME IN MULTIPLE BOXES. MAKE SURE YOU HAVE EVERYTHING BEFORE ASSEMBLY.

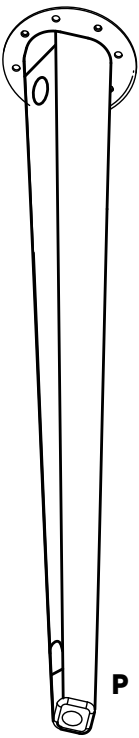
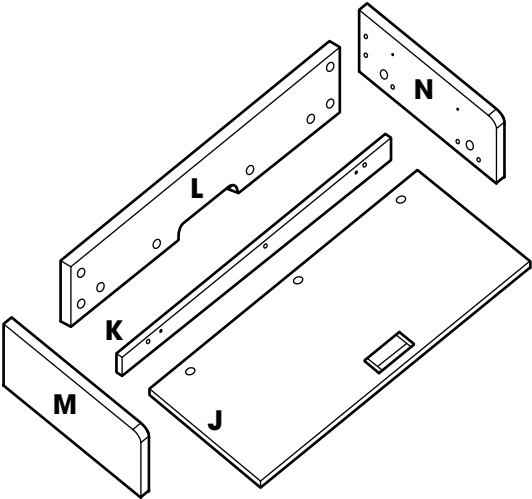
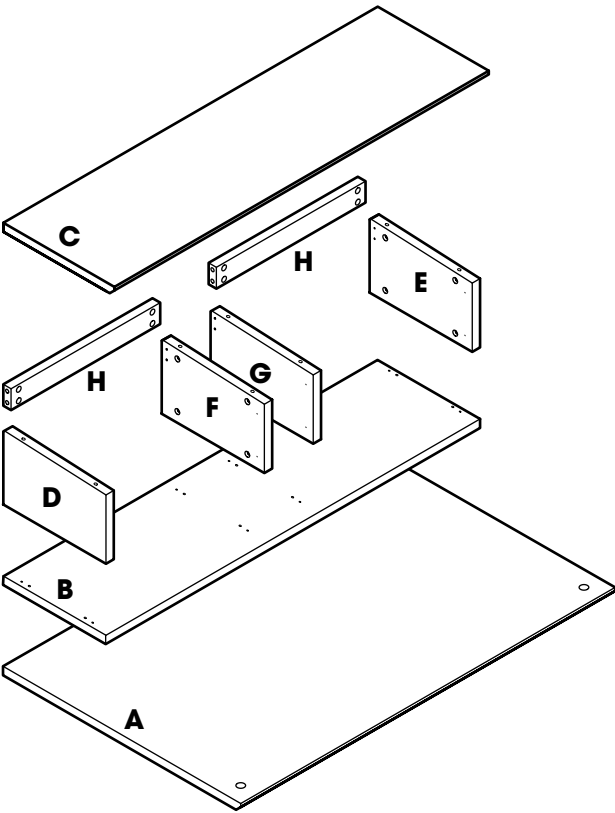

4x

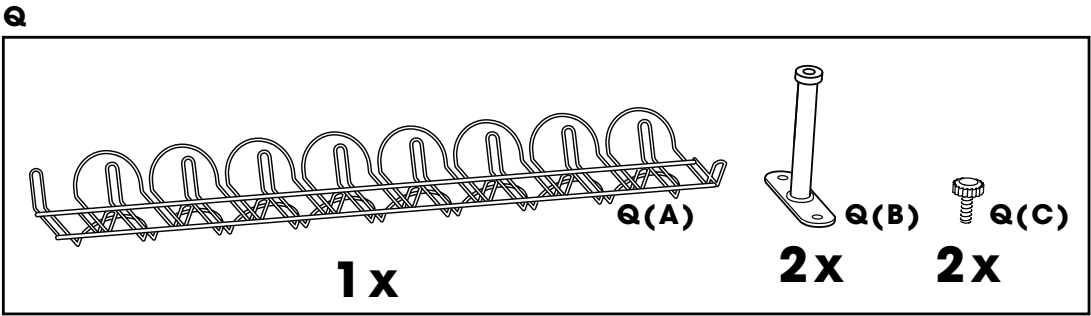

1x

2x

2x

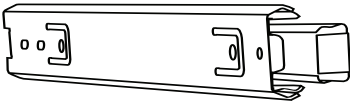

2x

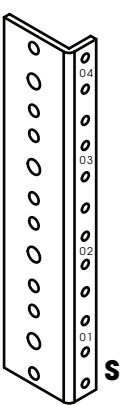

2x

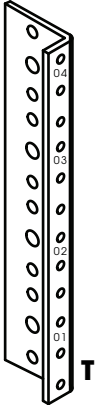

2x

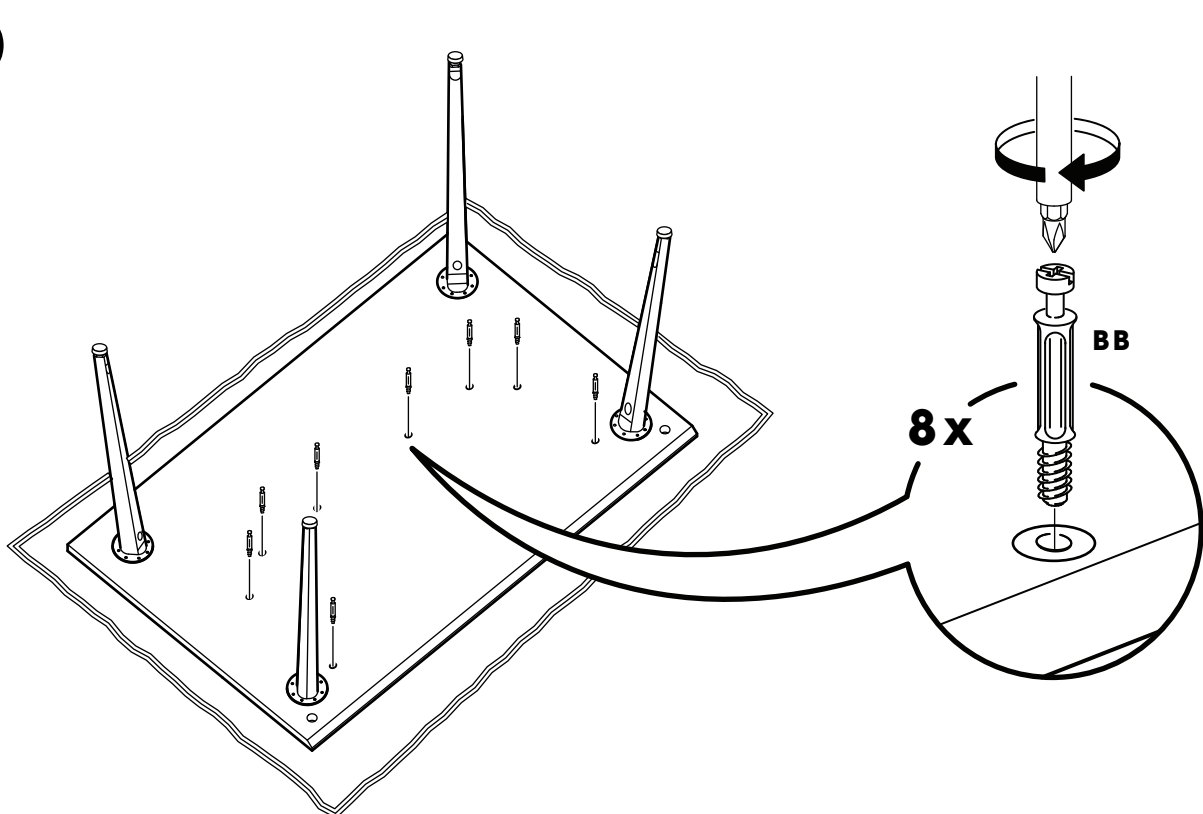
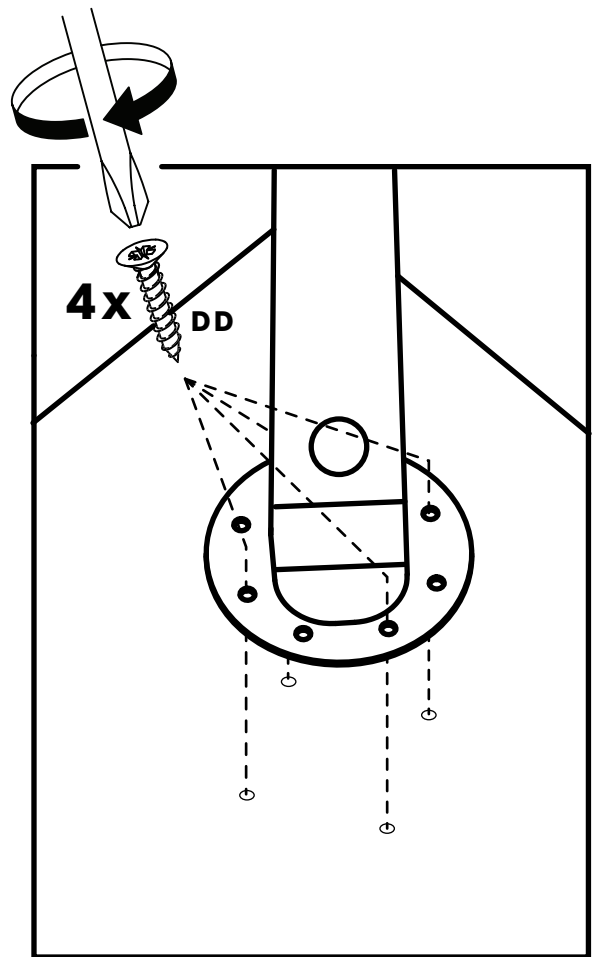
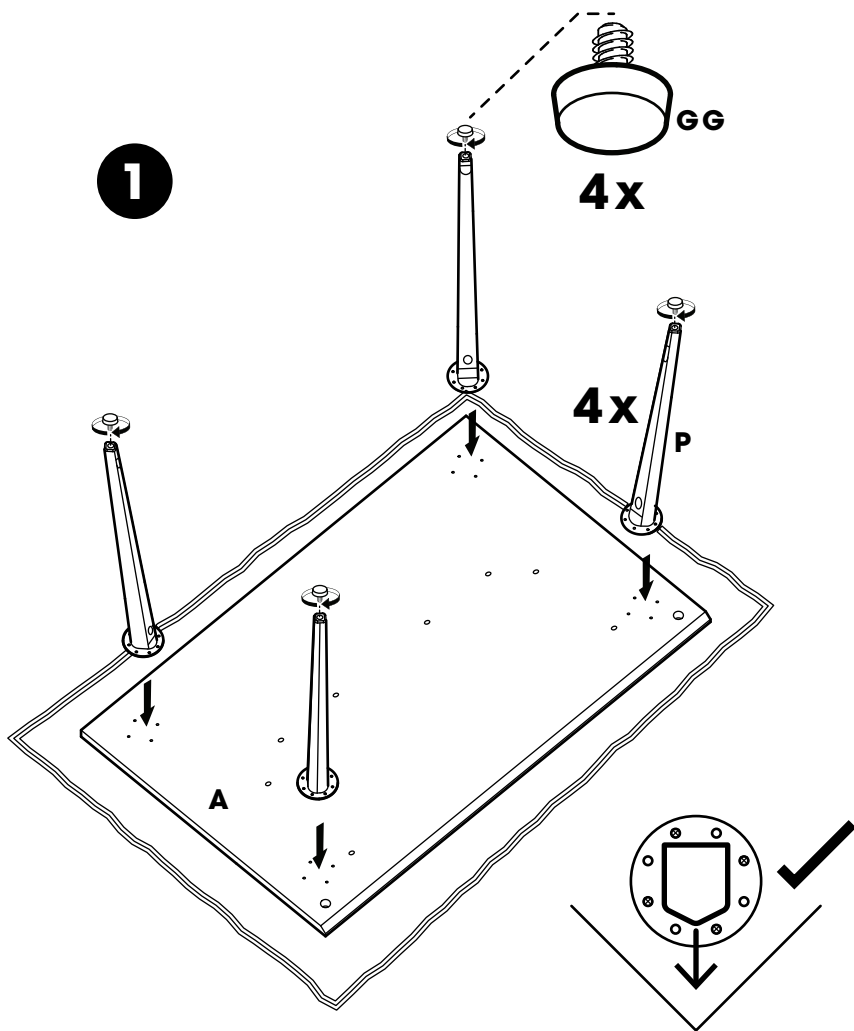

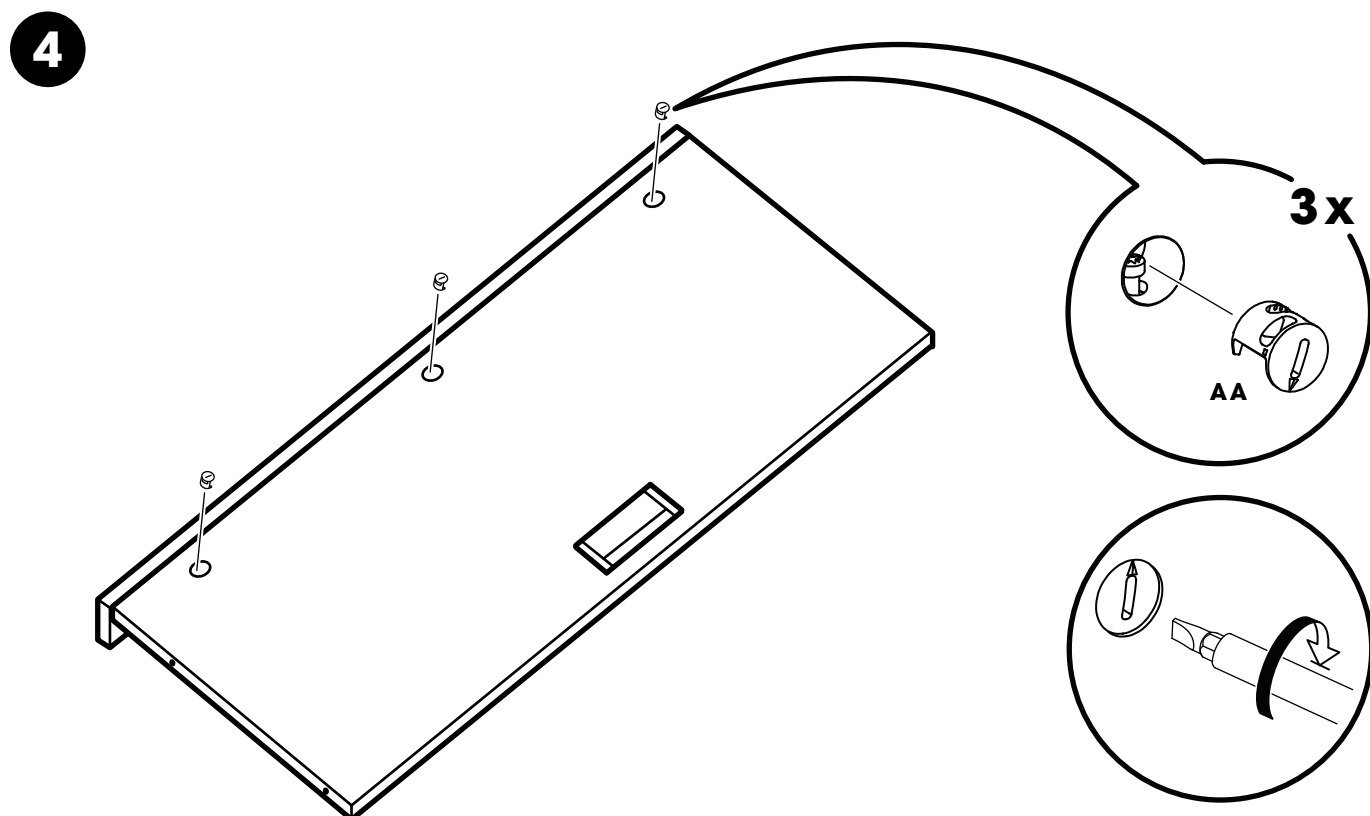
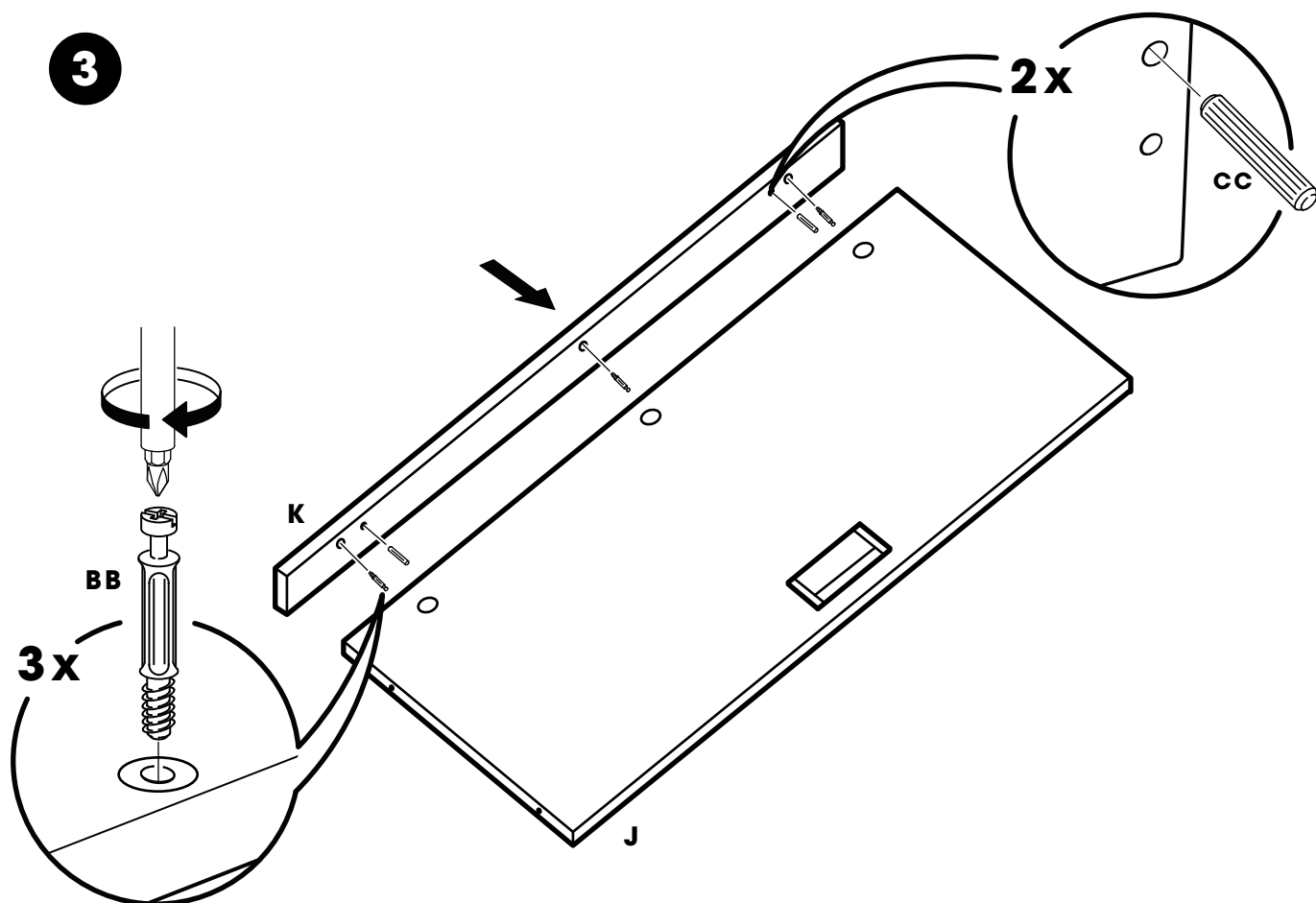

5

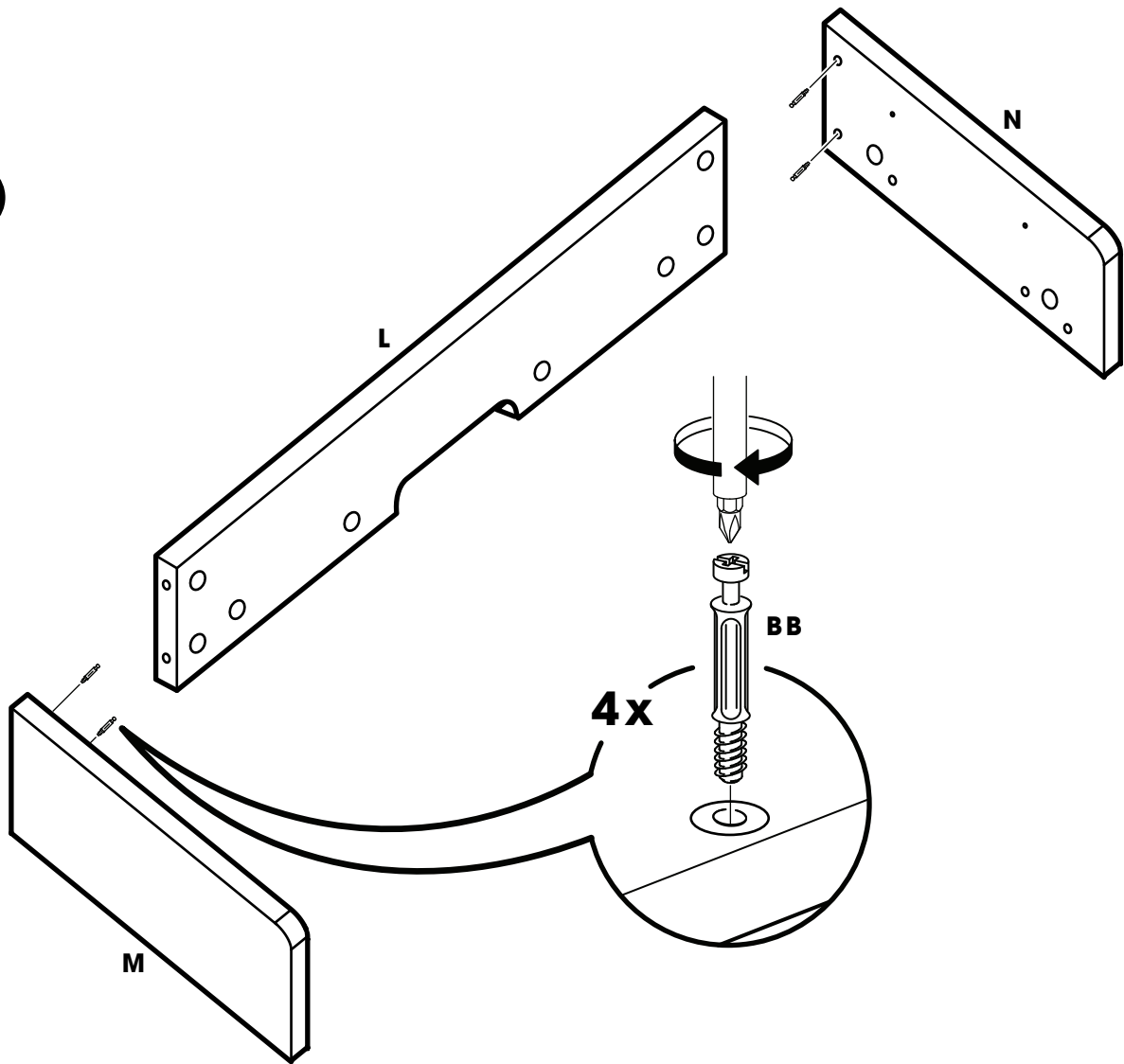

6

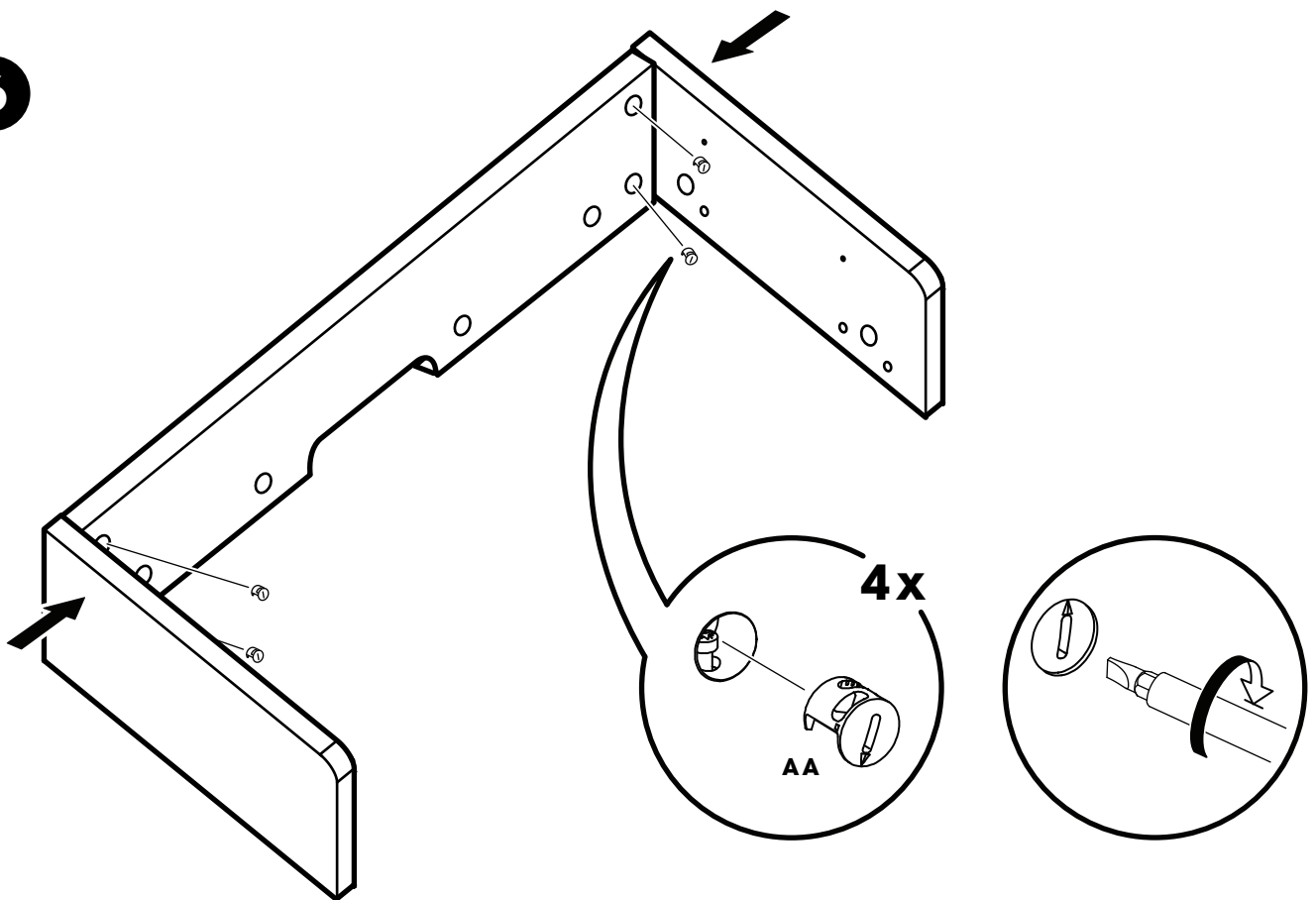

7

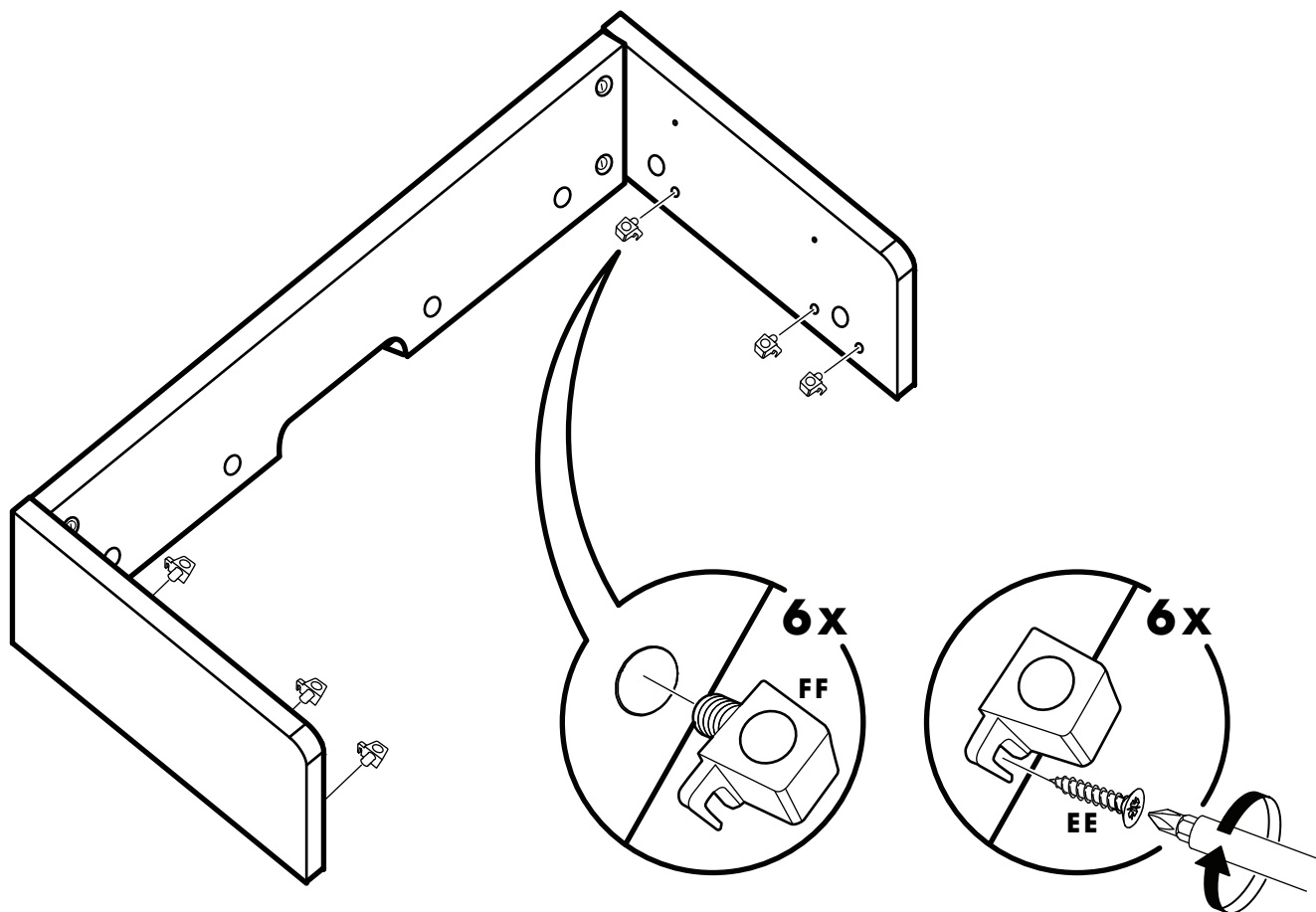

8

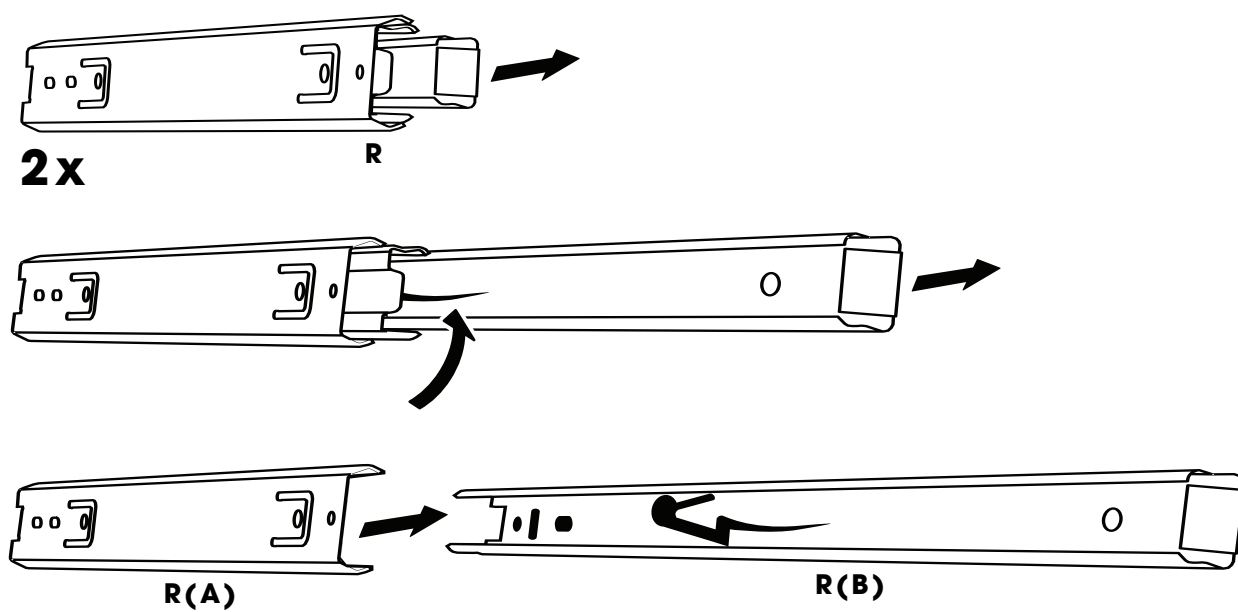

9

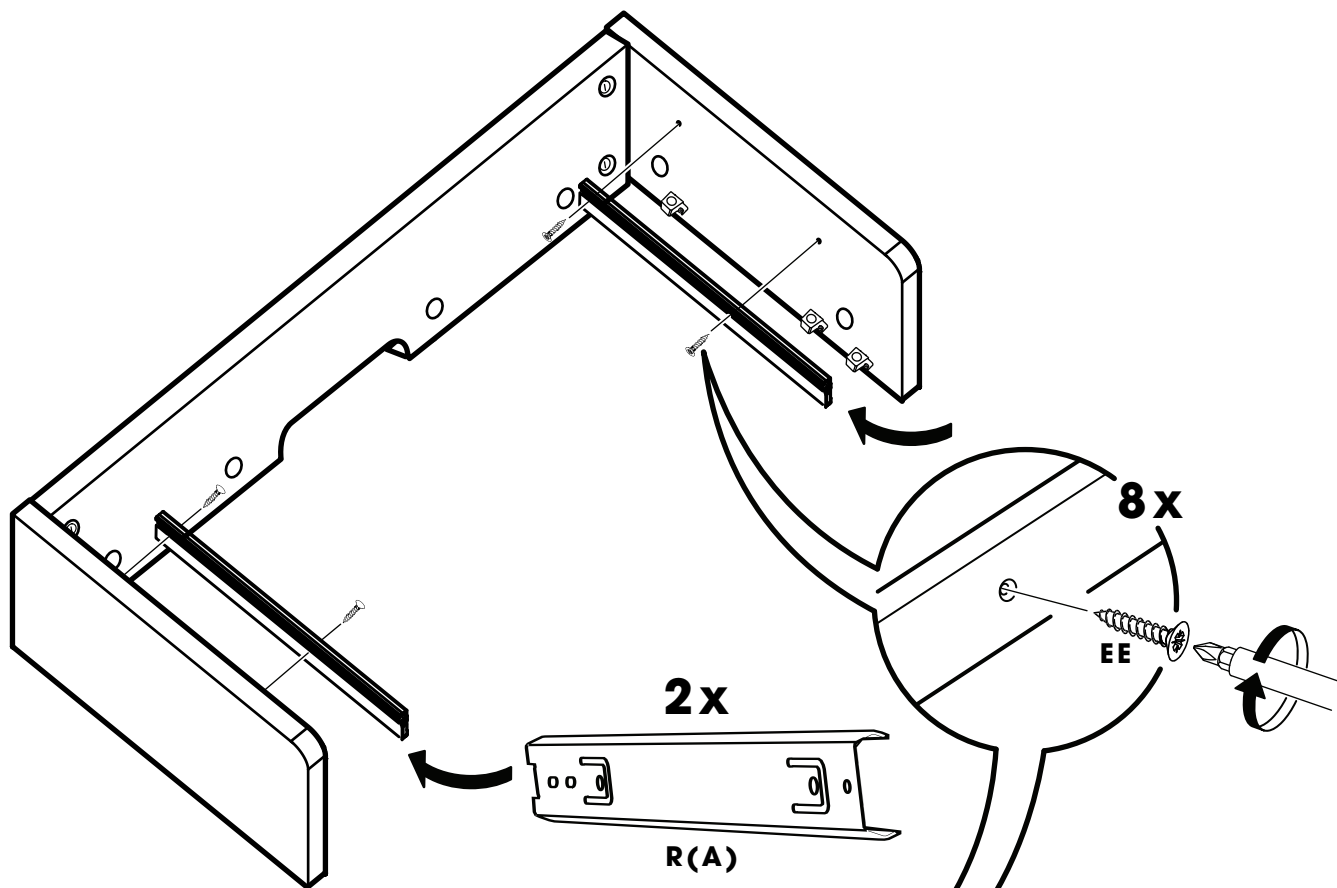

10

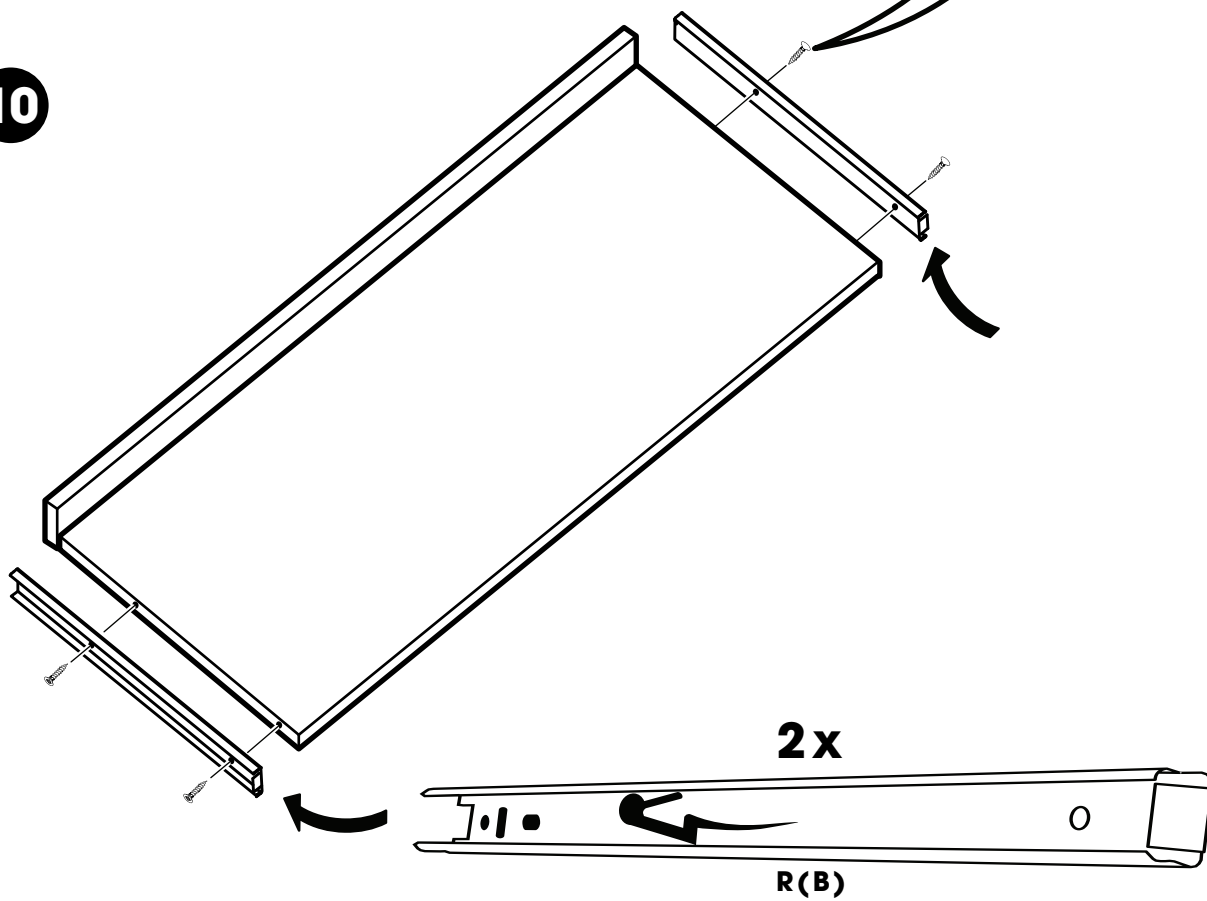

11

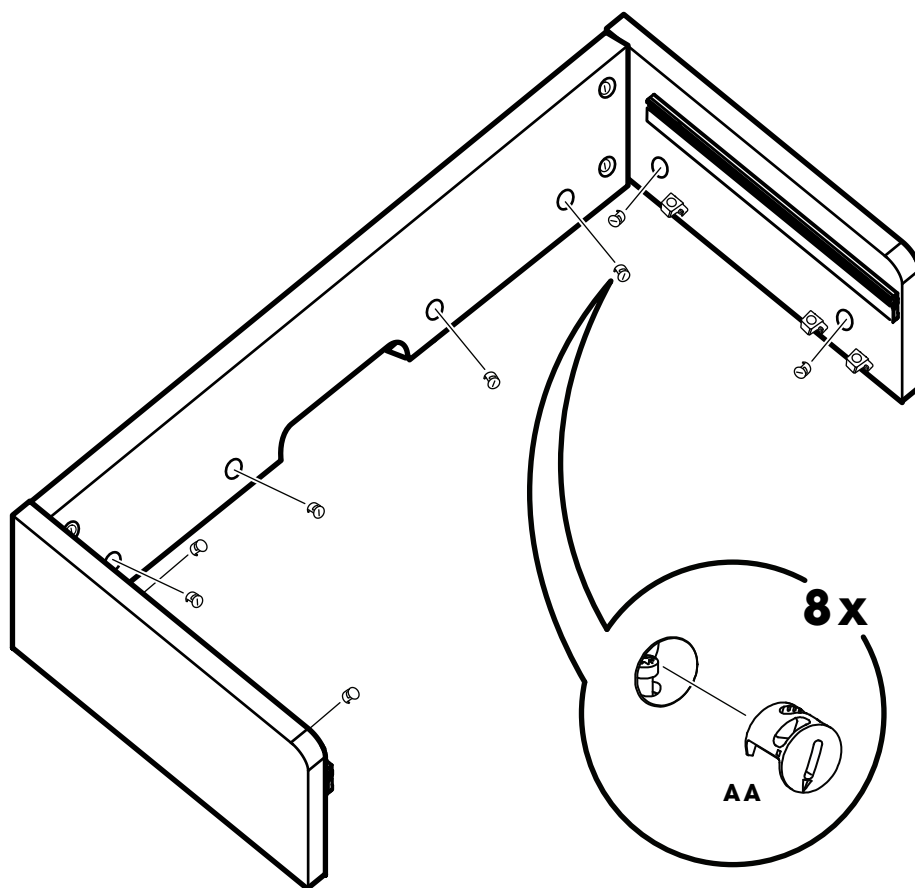

12

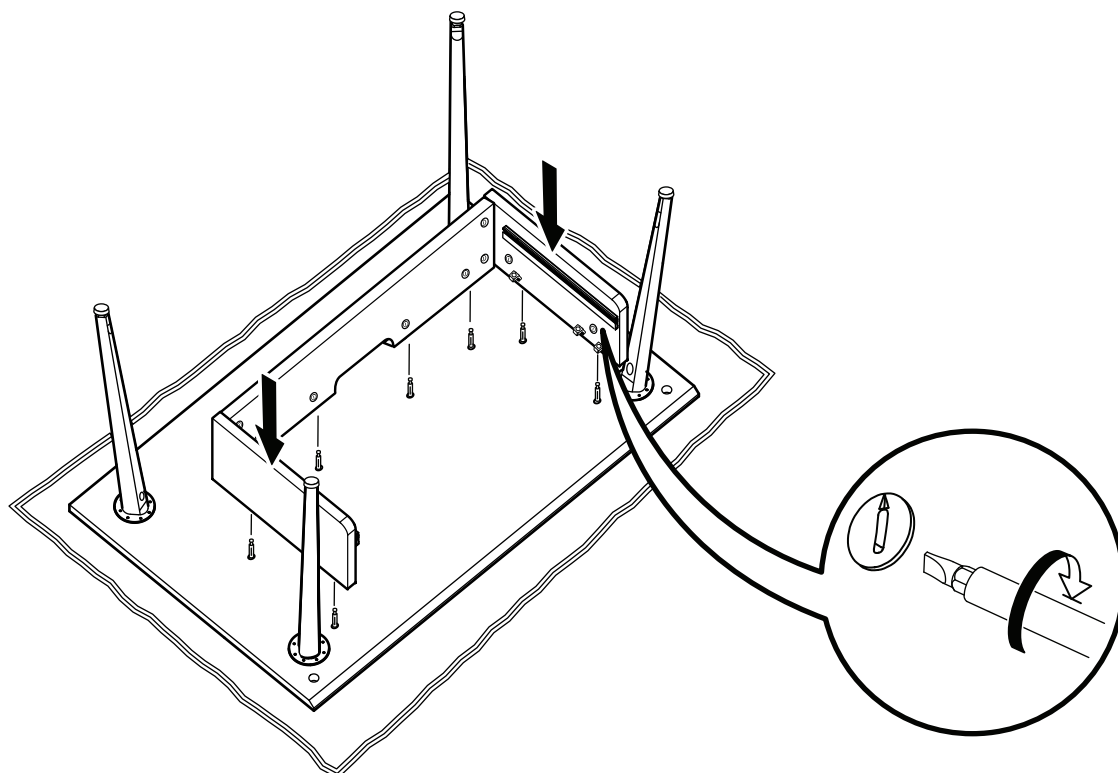

13

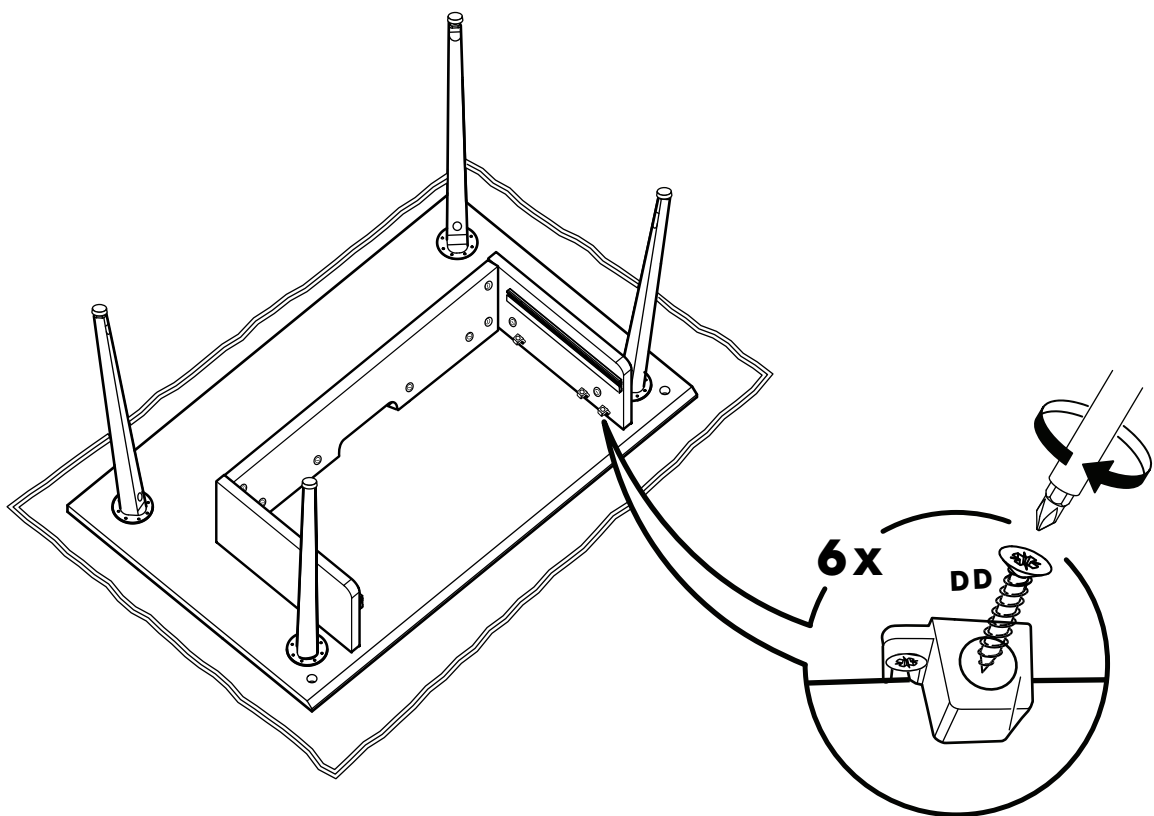

14

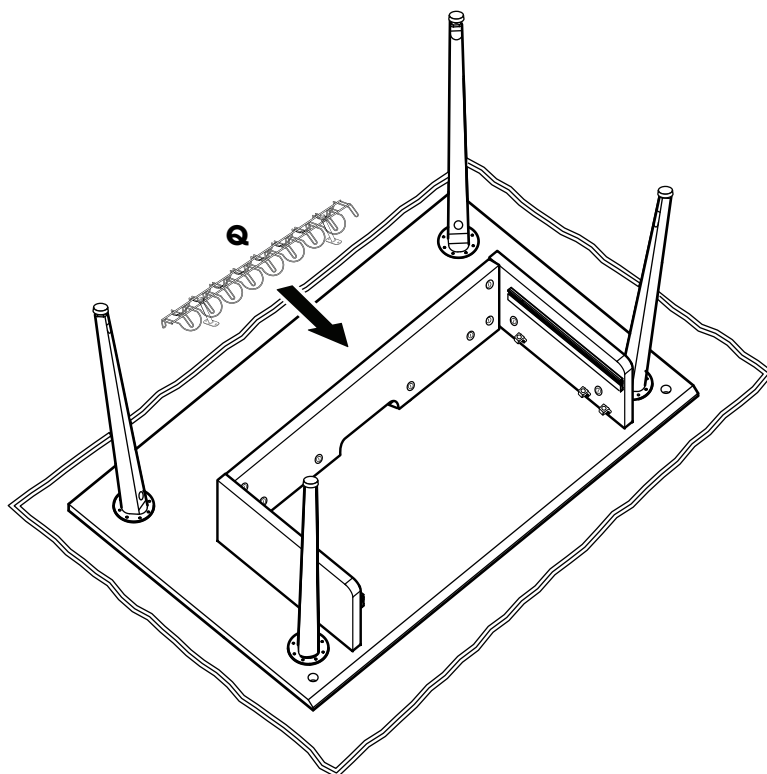

15

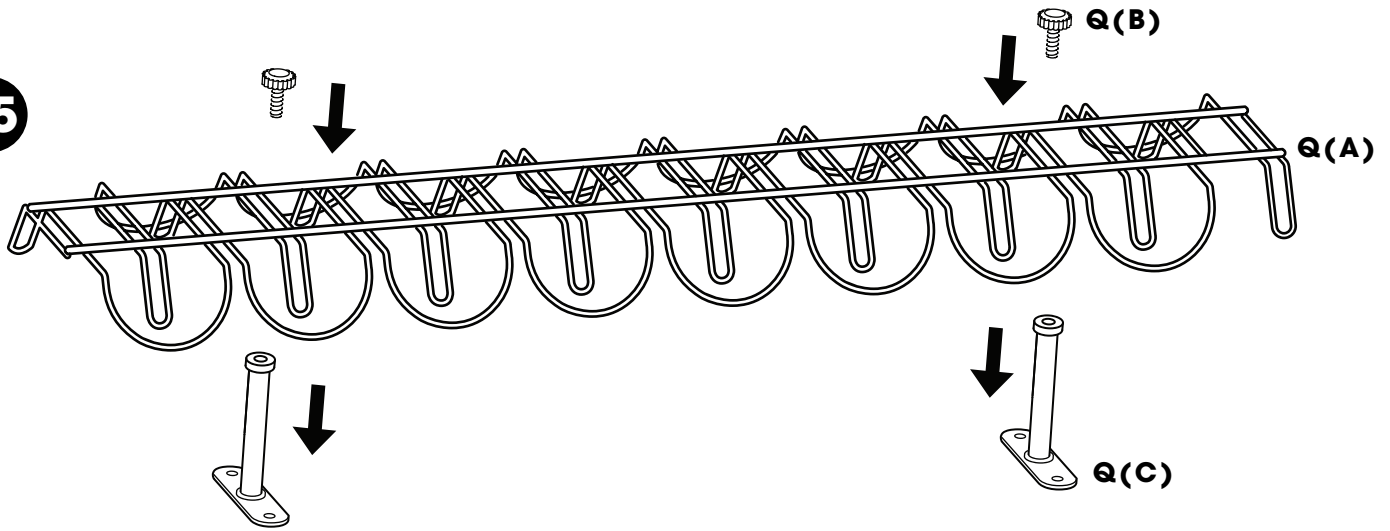

16

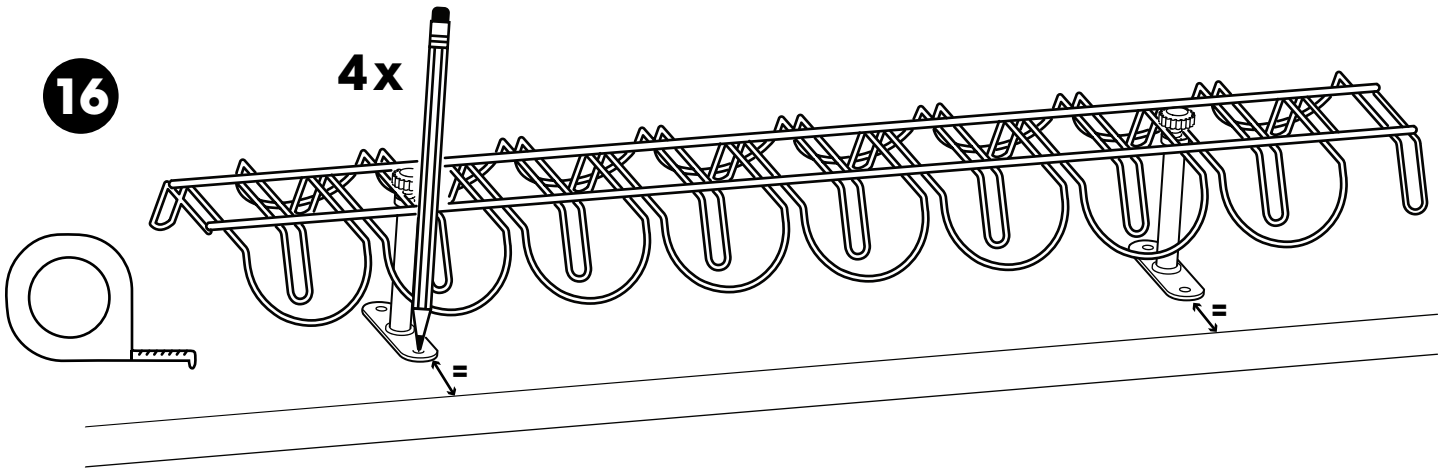

17

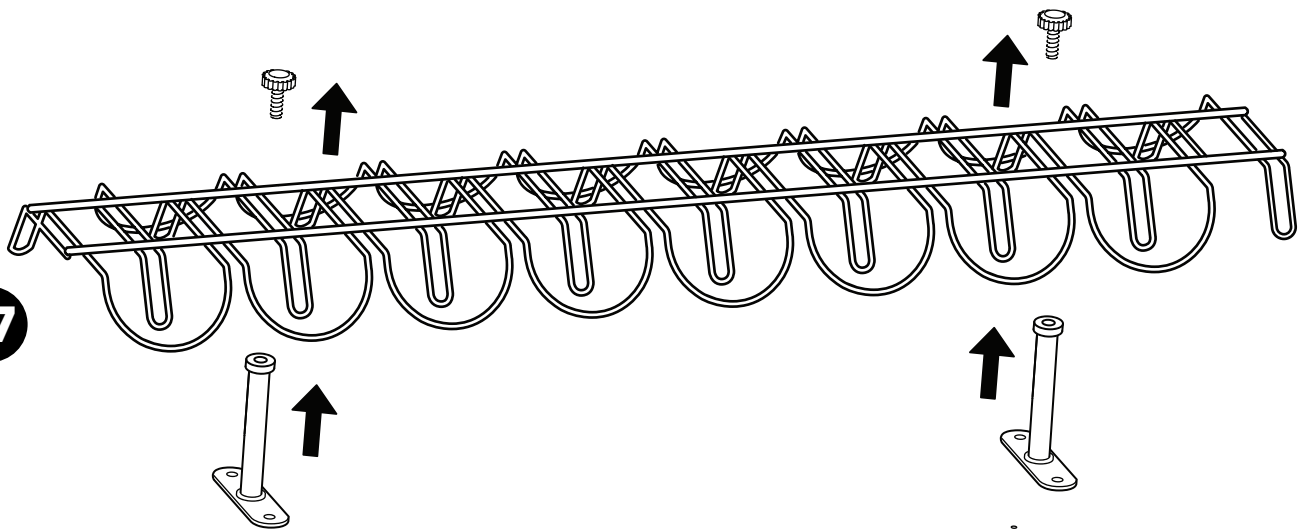

18

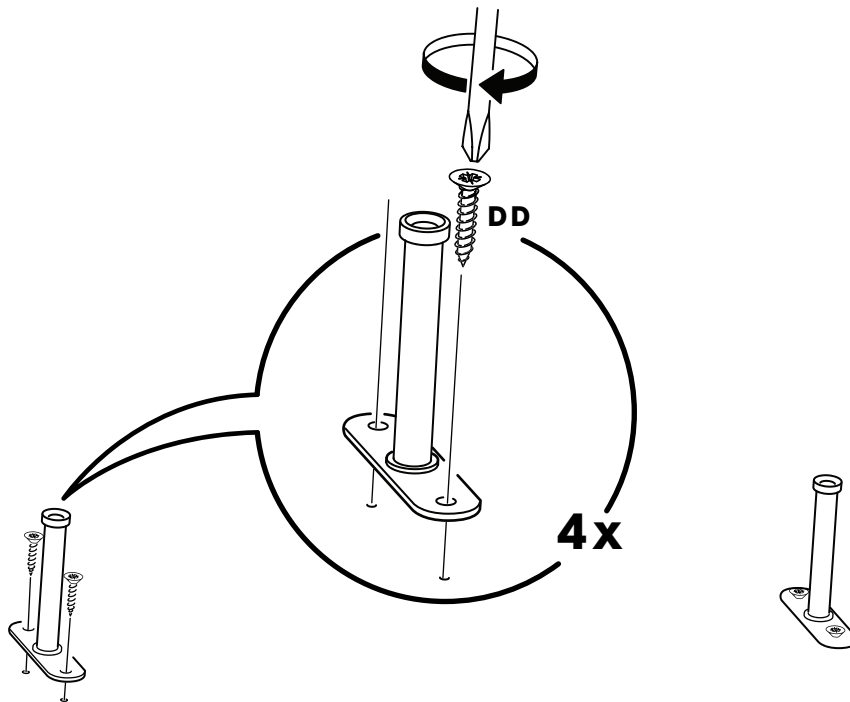

19

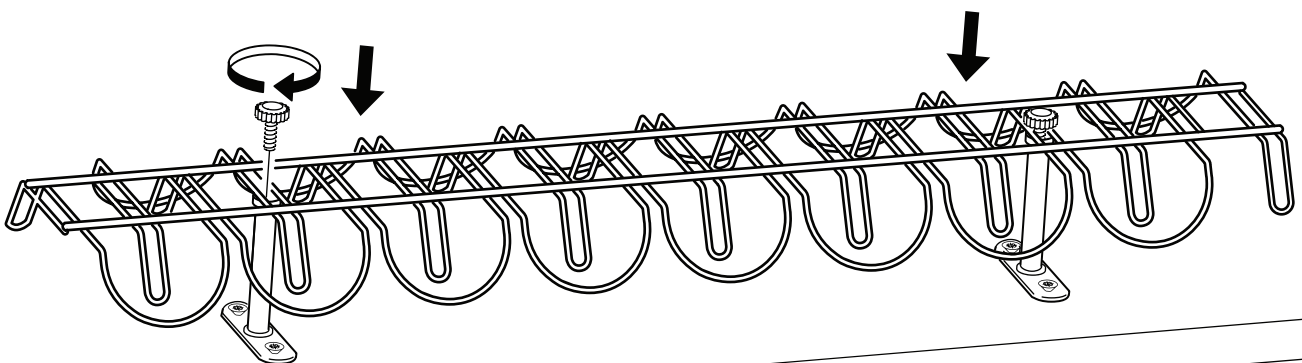

20

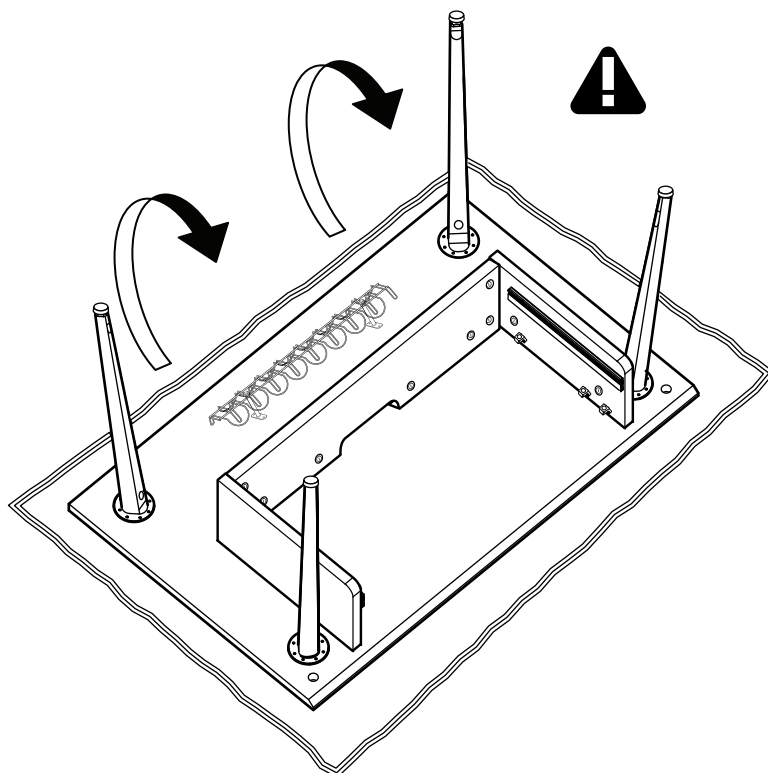

21

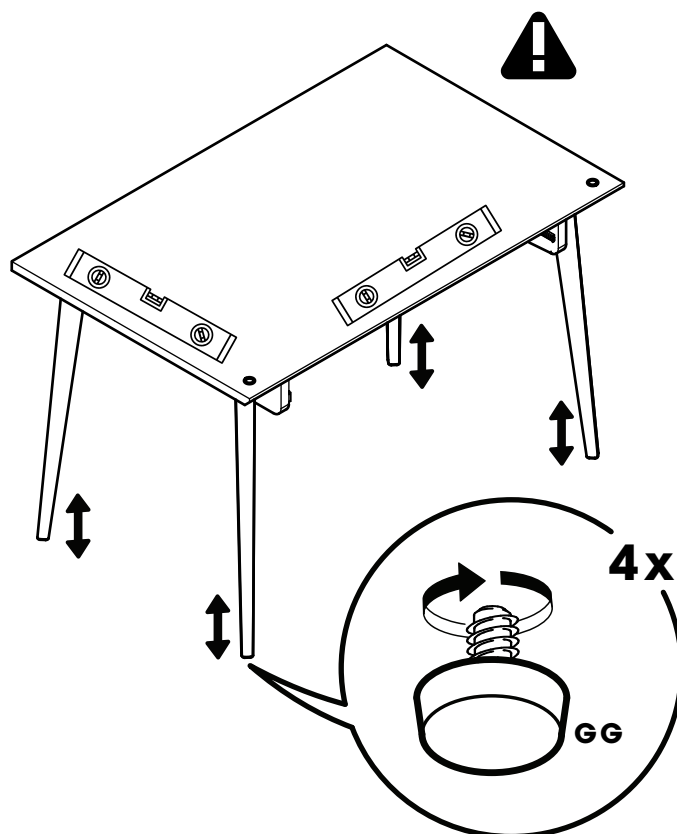

22

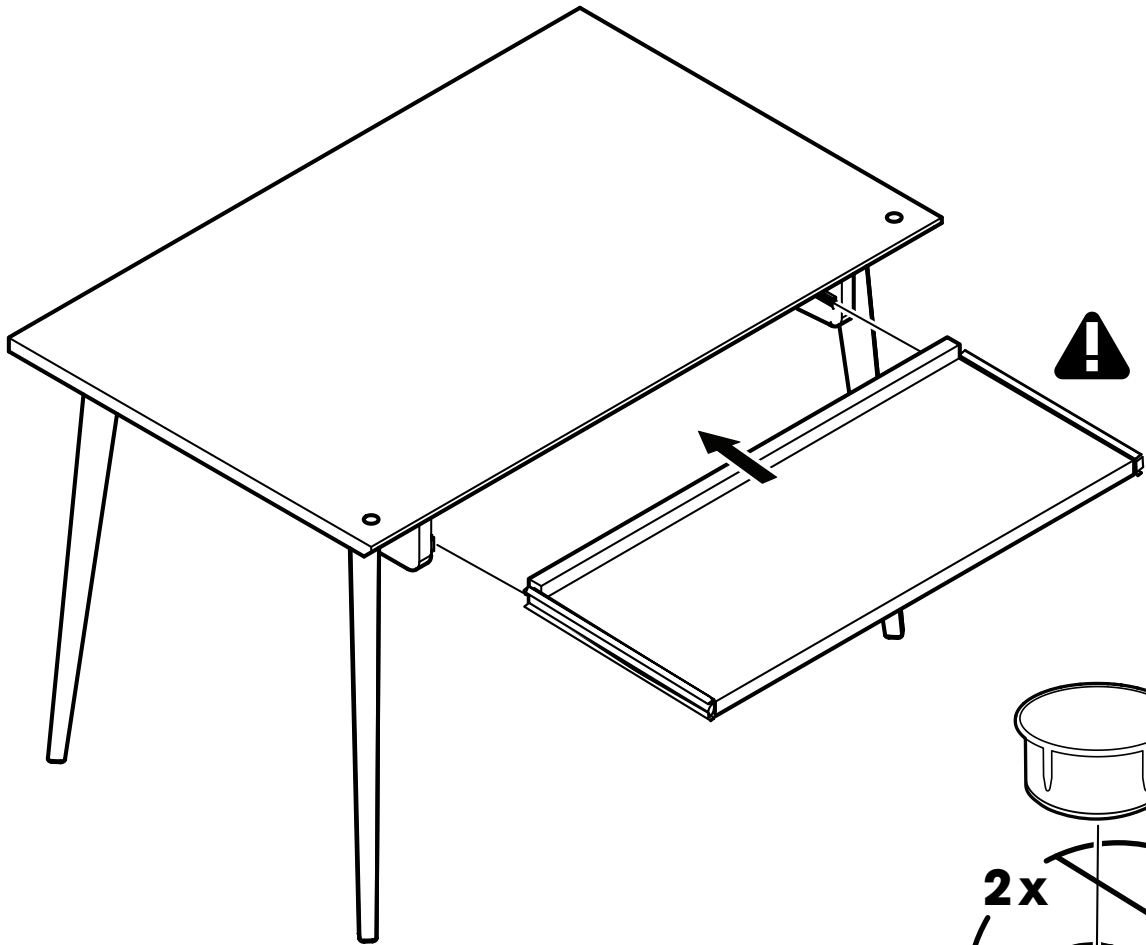

23

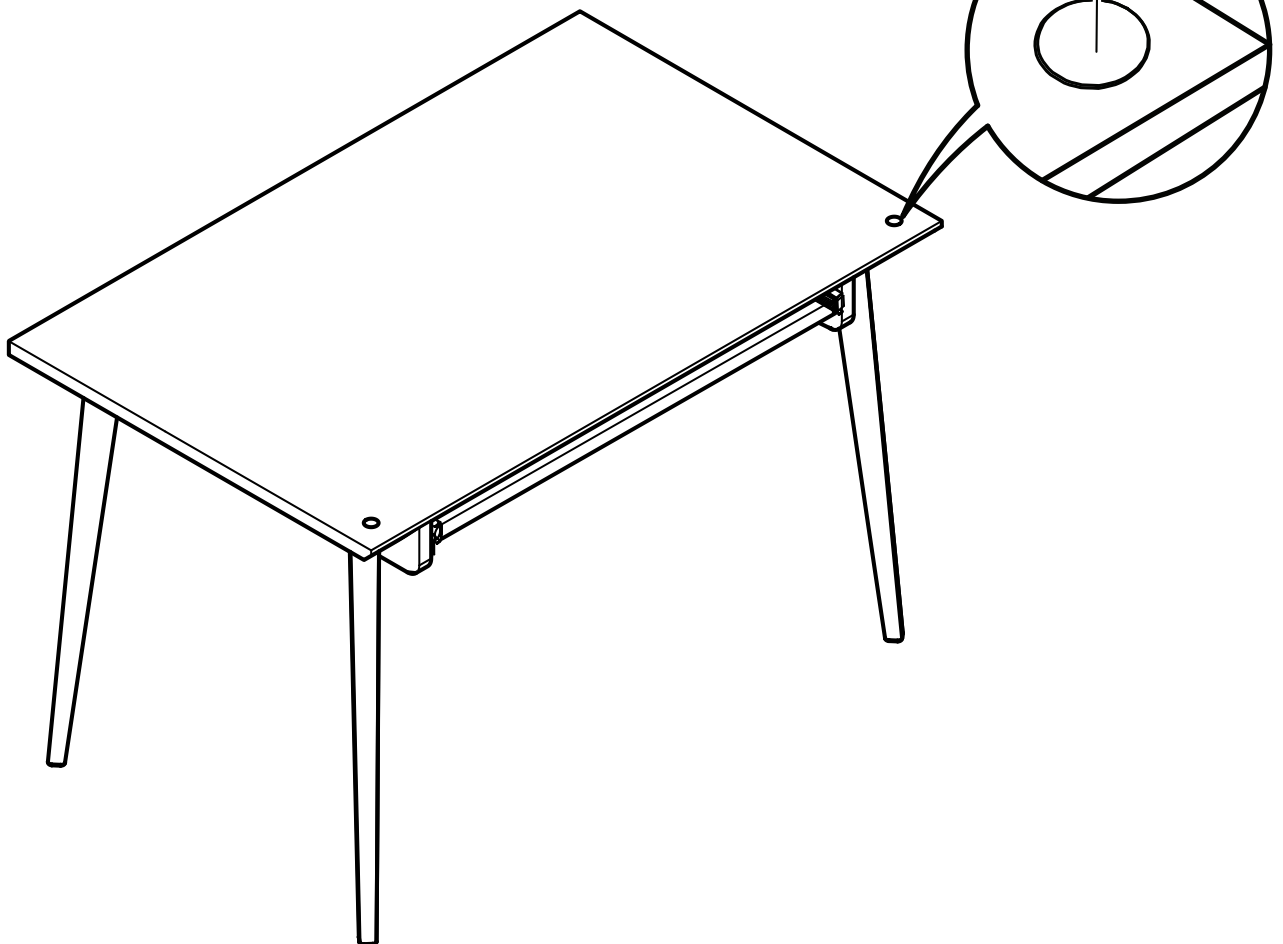

24

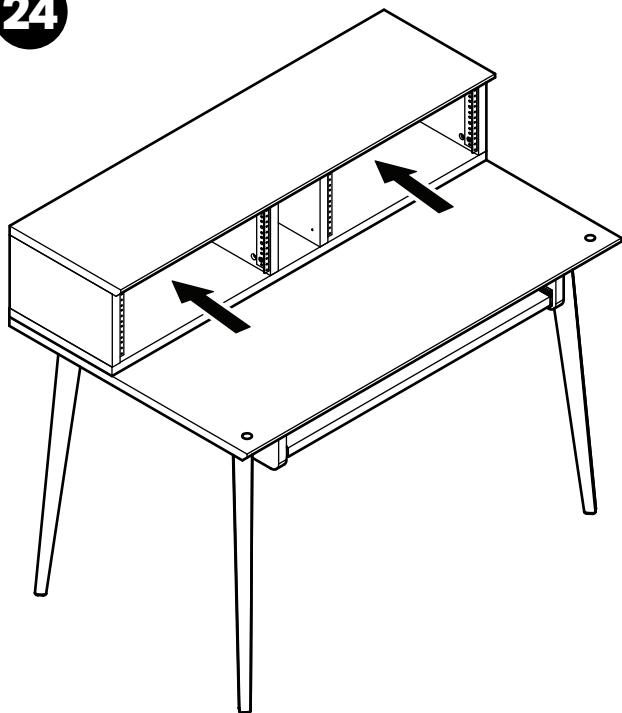

i

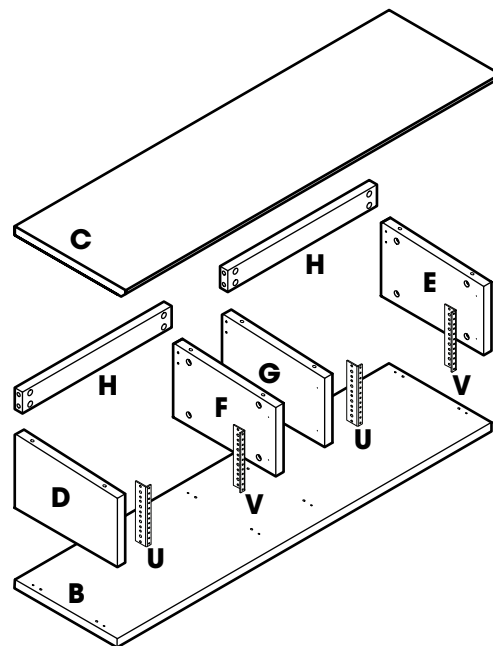

25

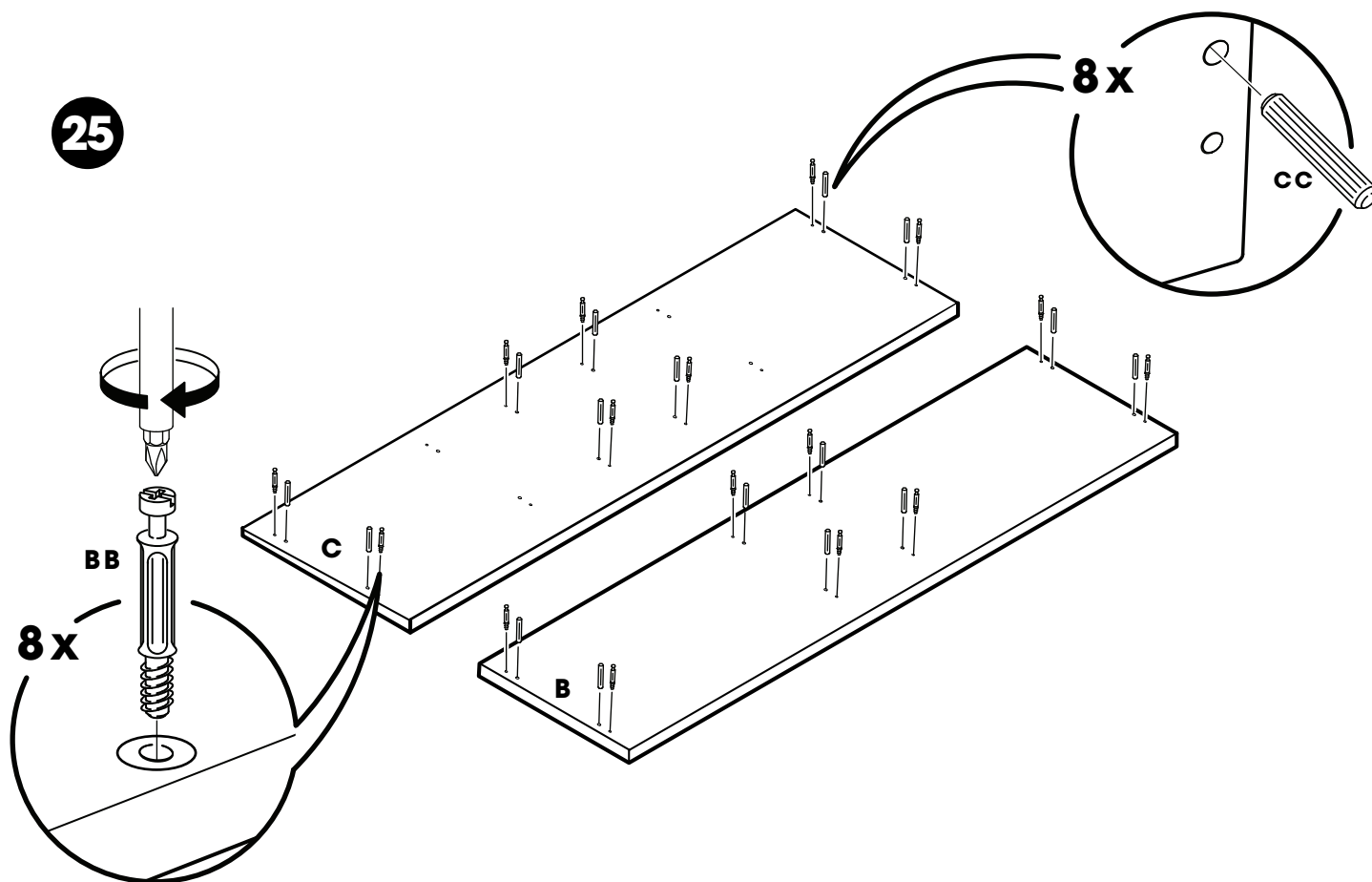

26

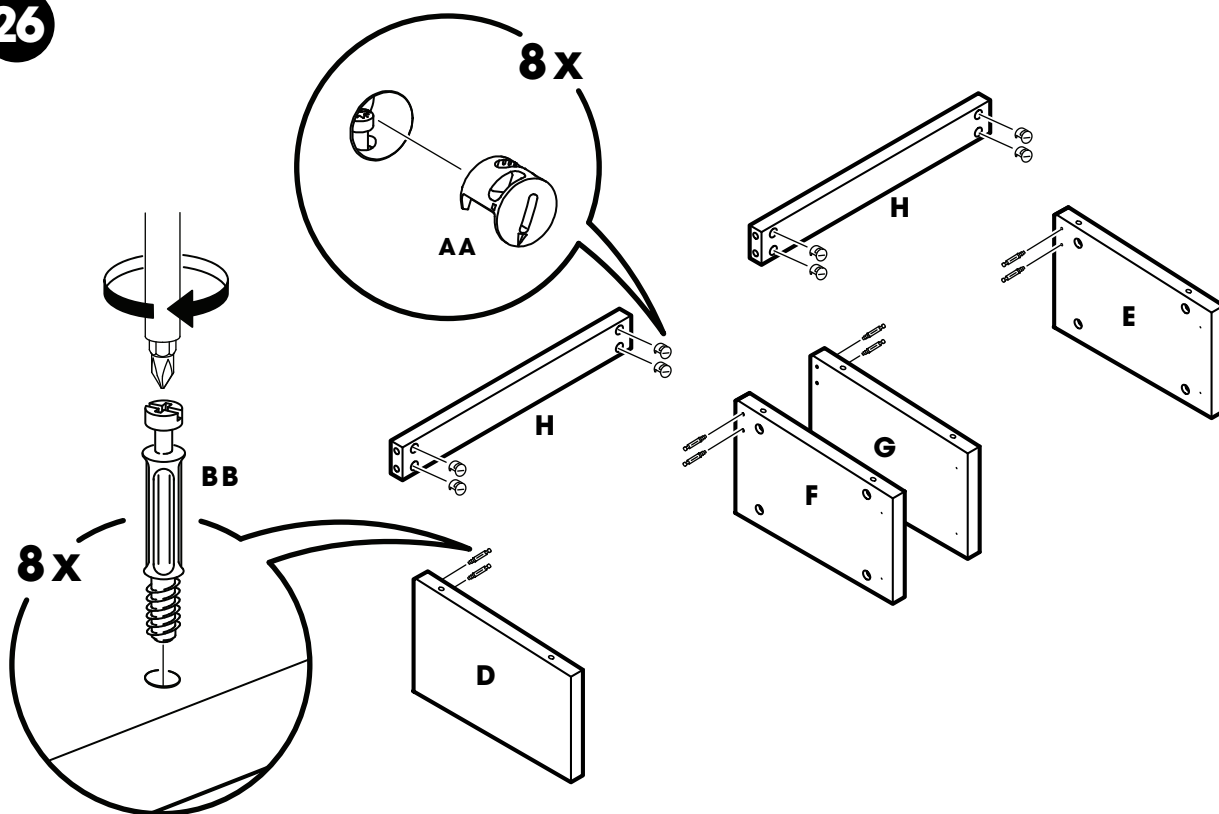

27

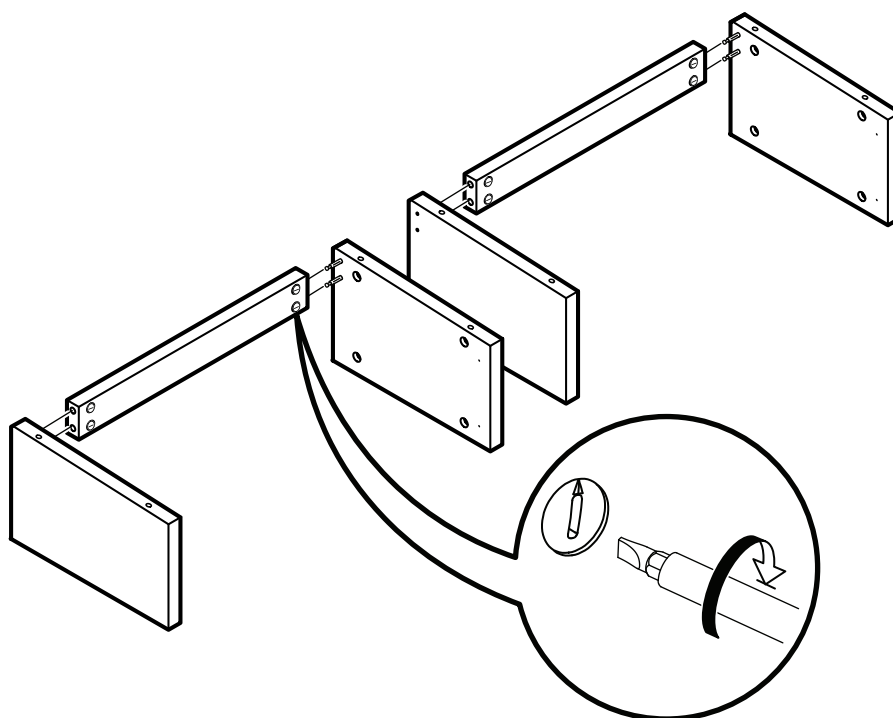

28

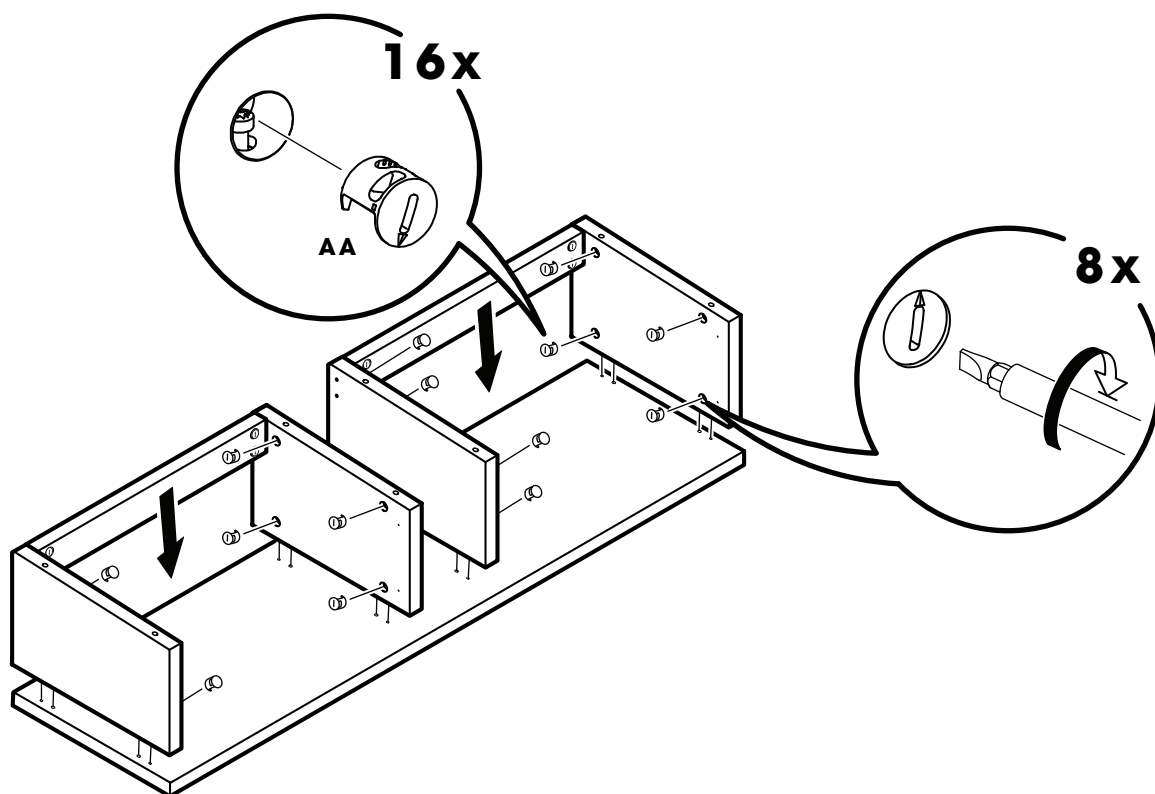

29

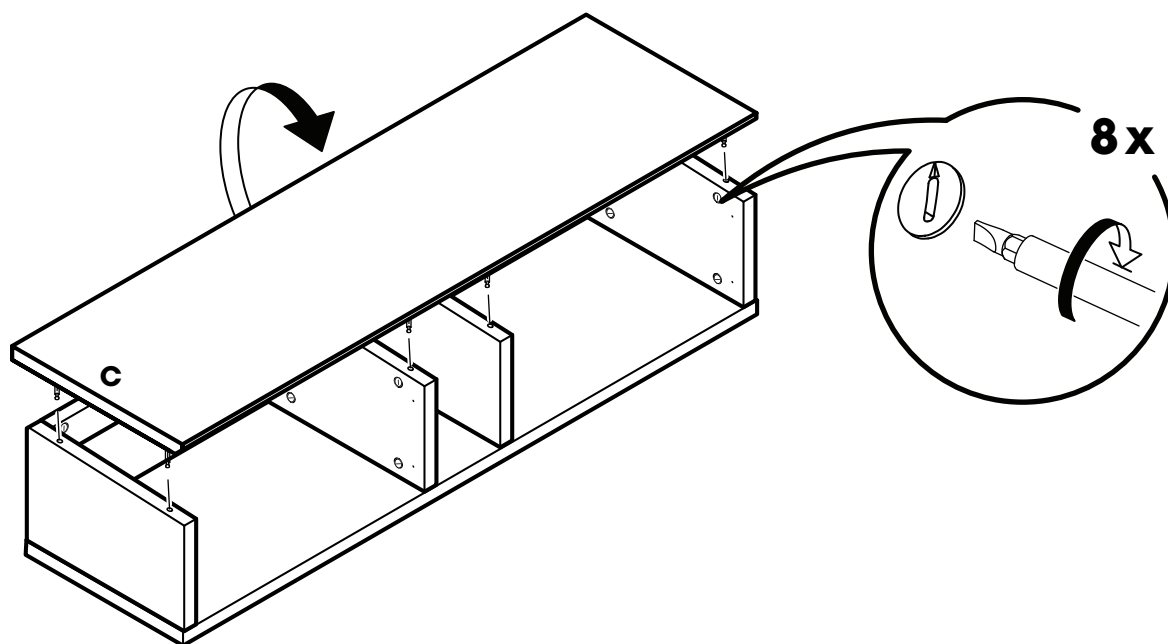

30

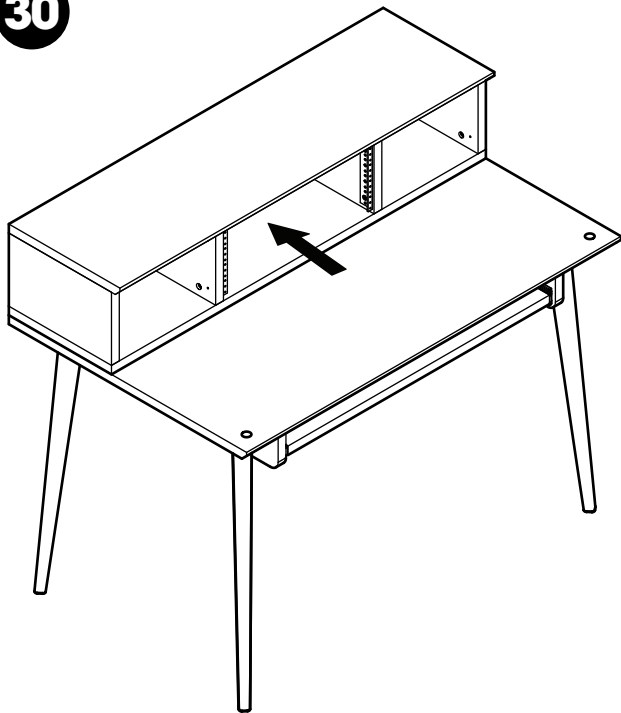

i

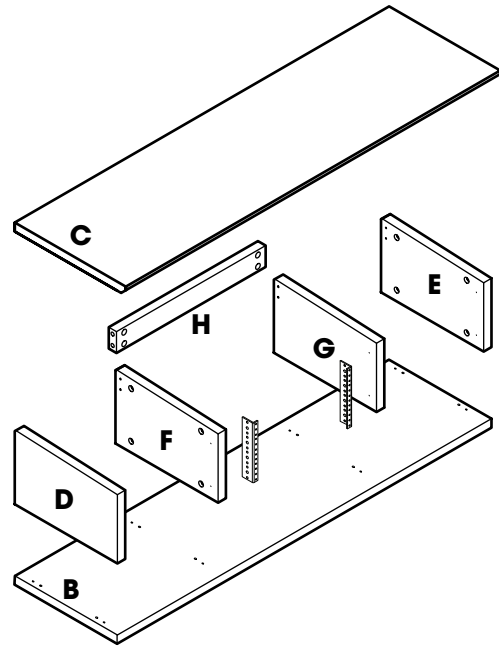

31

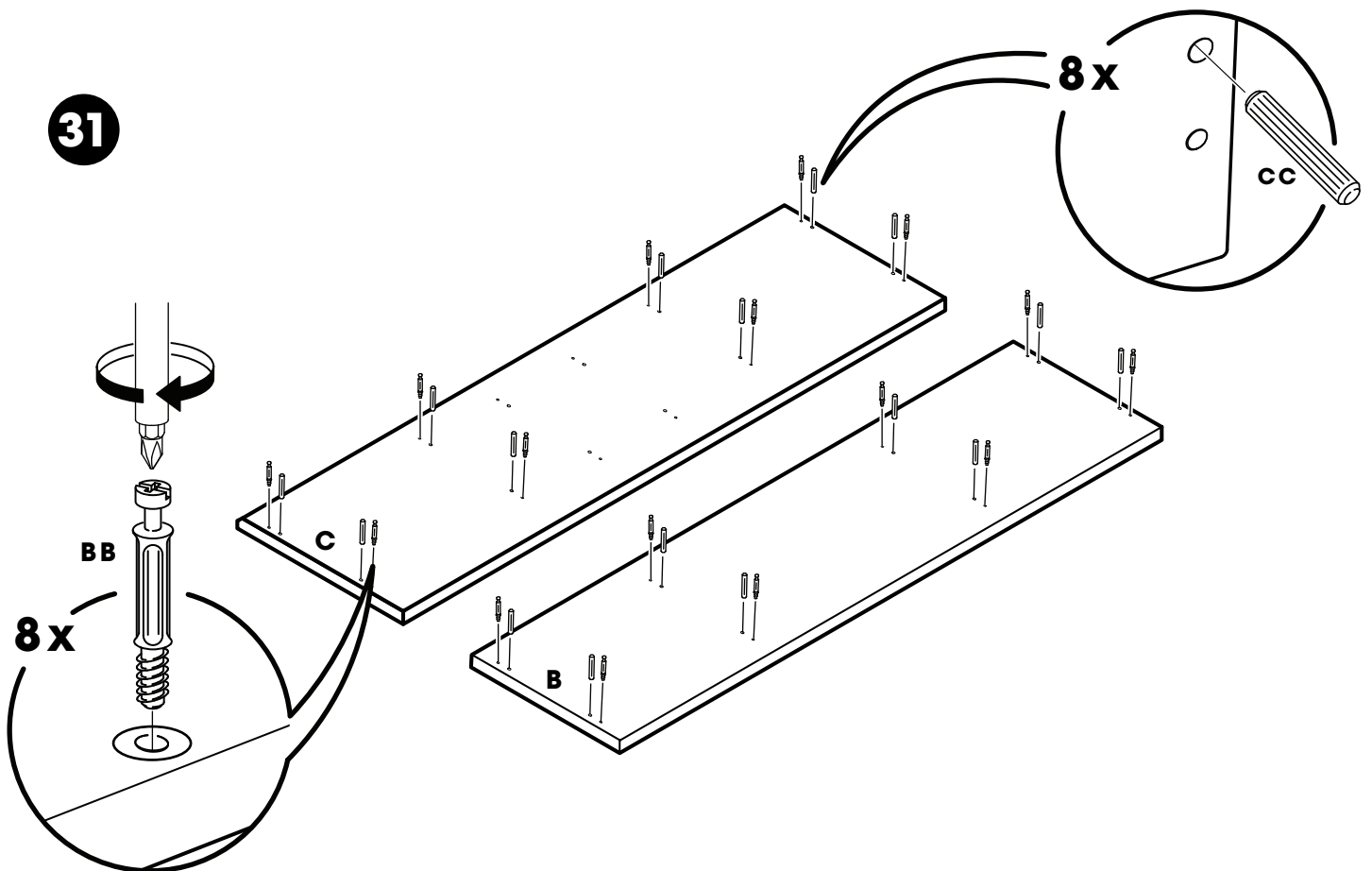

32

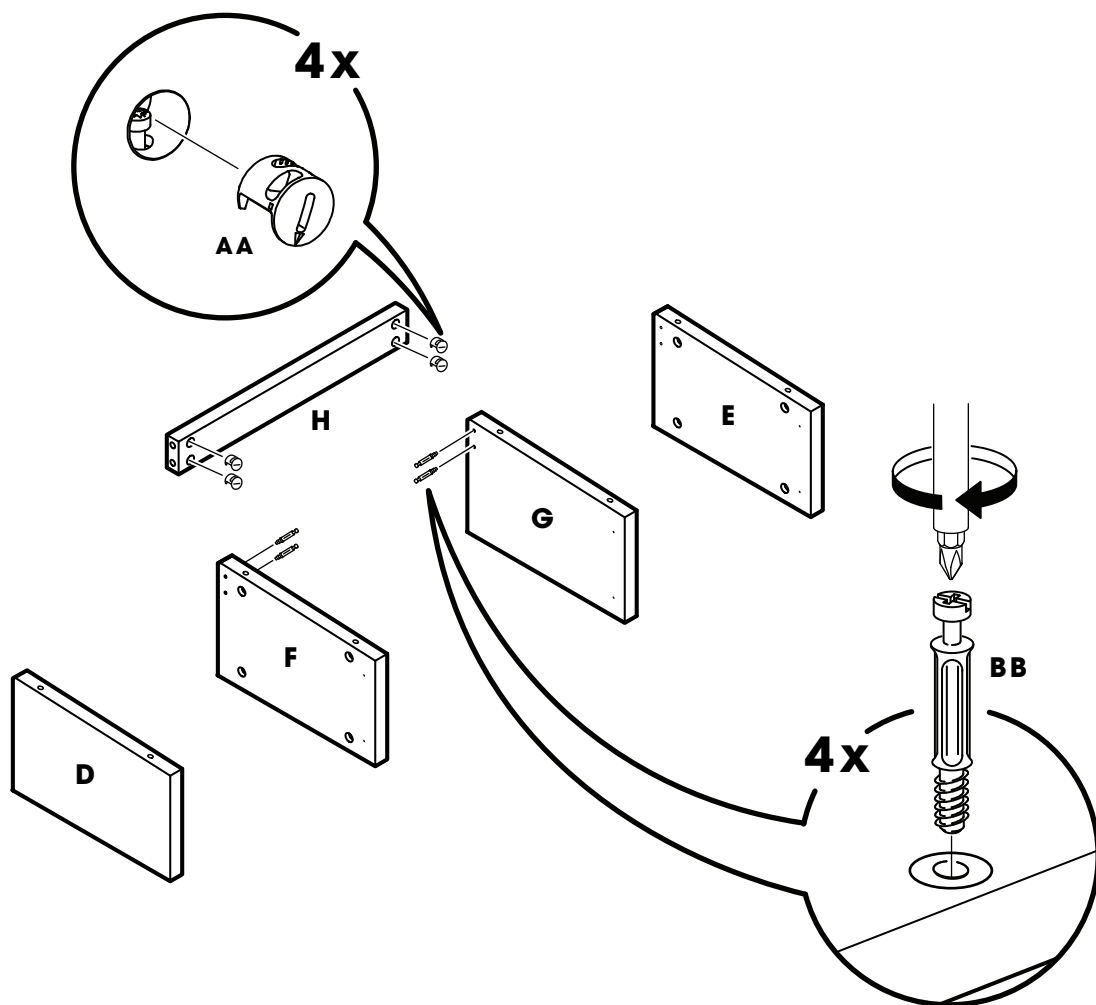

33

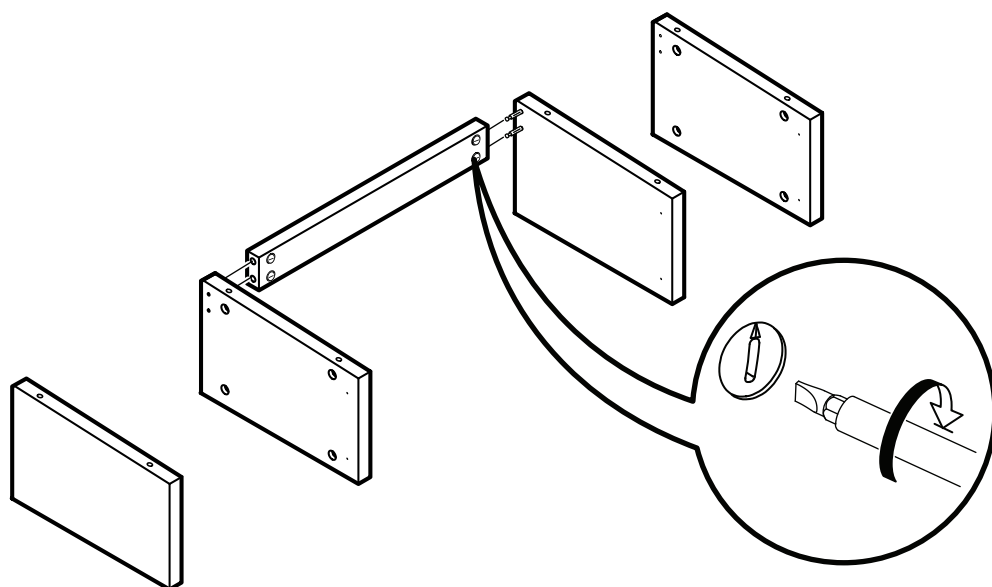

34

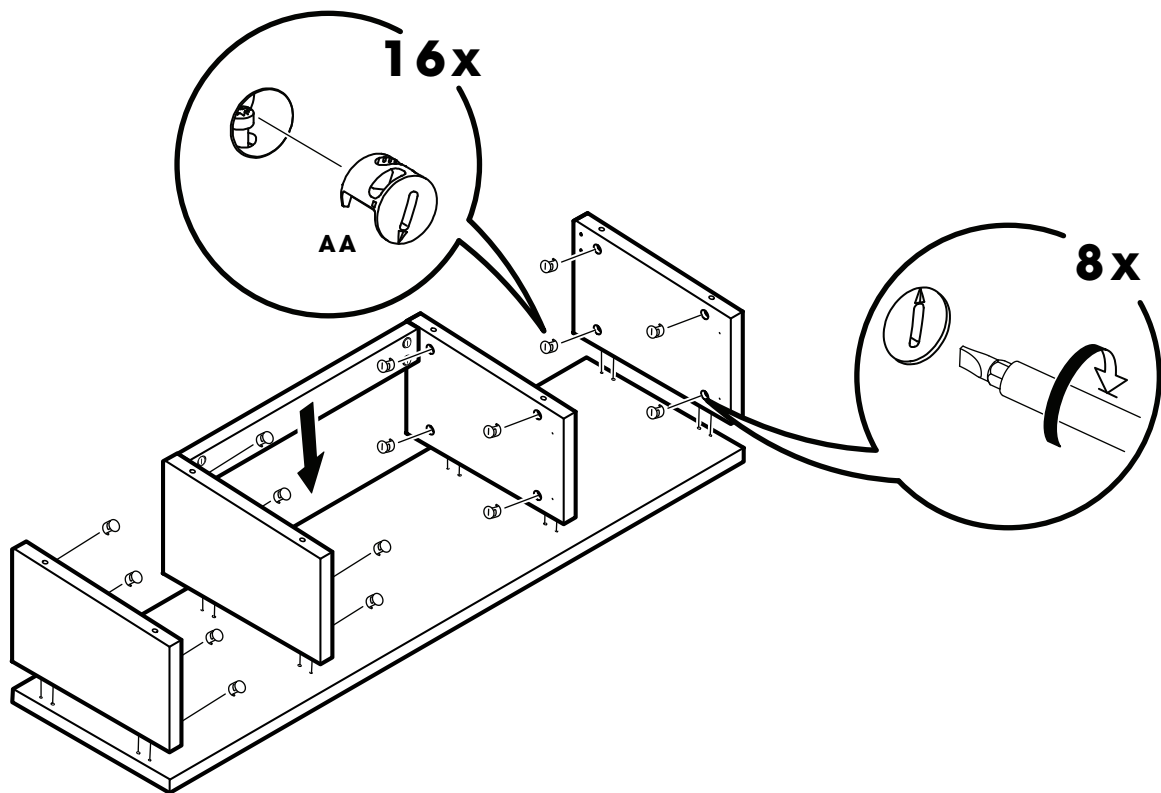

35

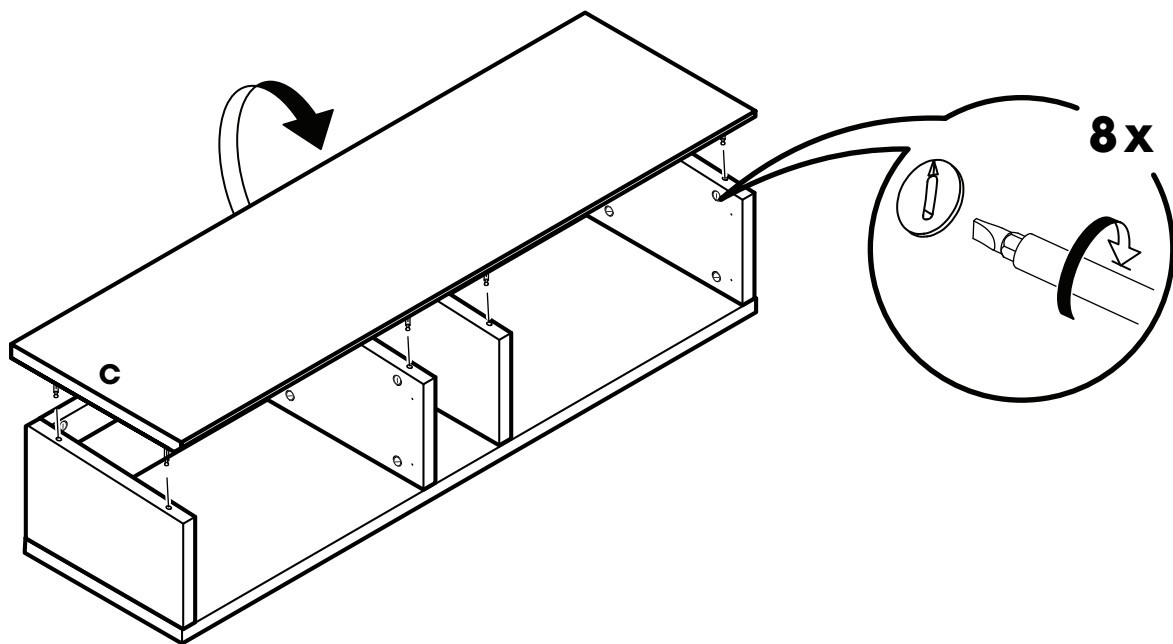

36

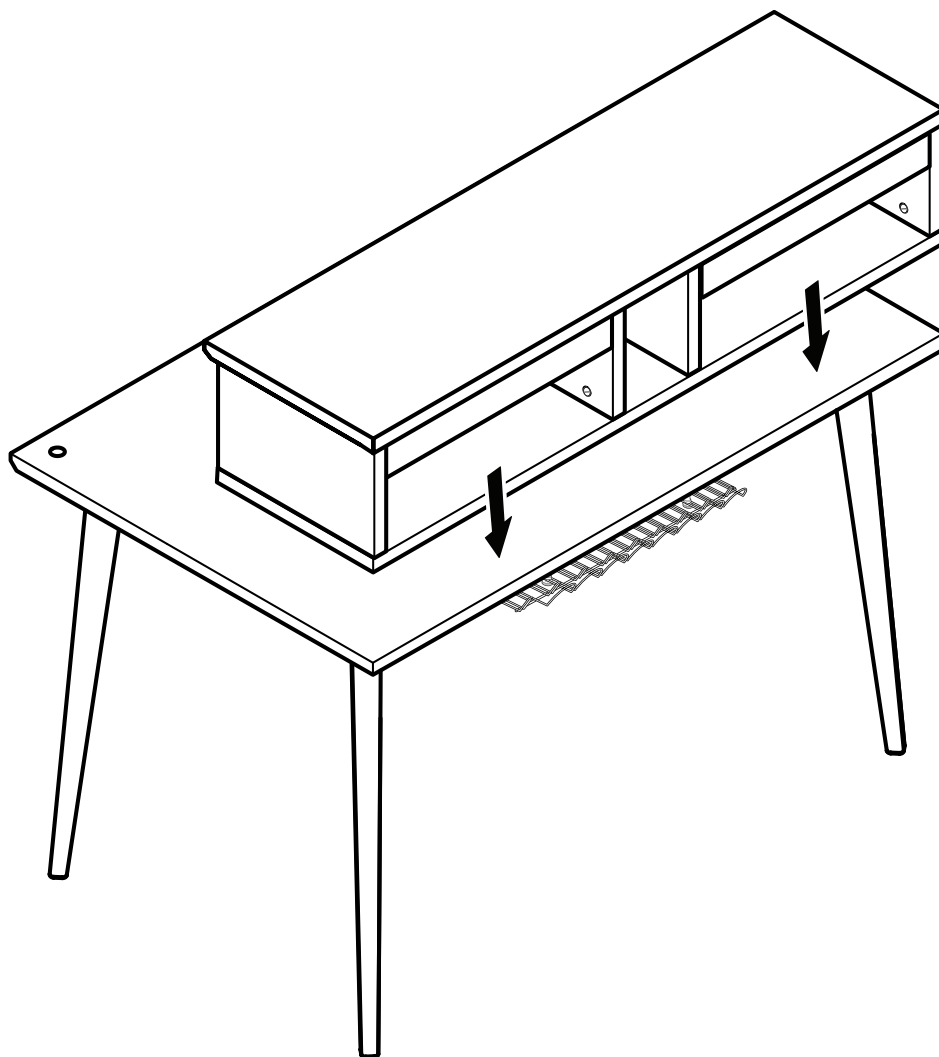

37

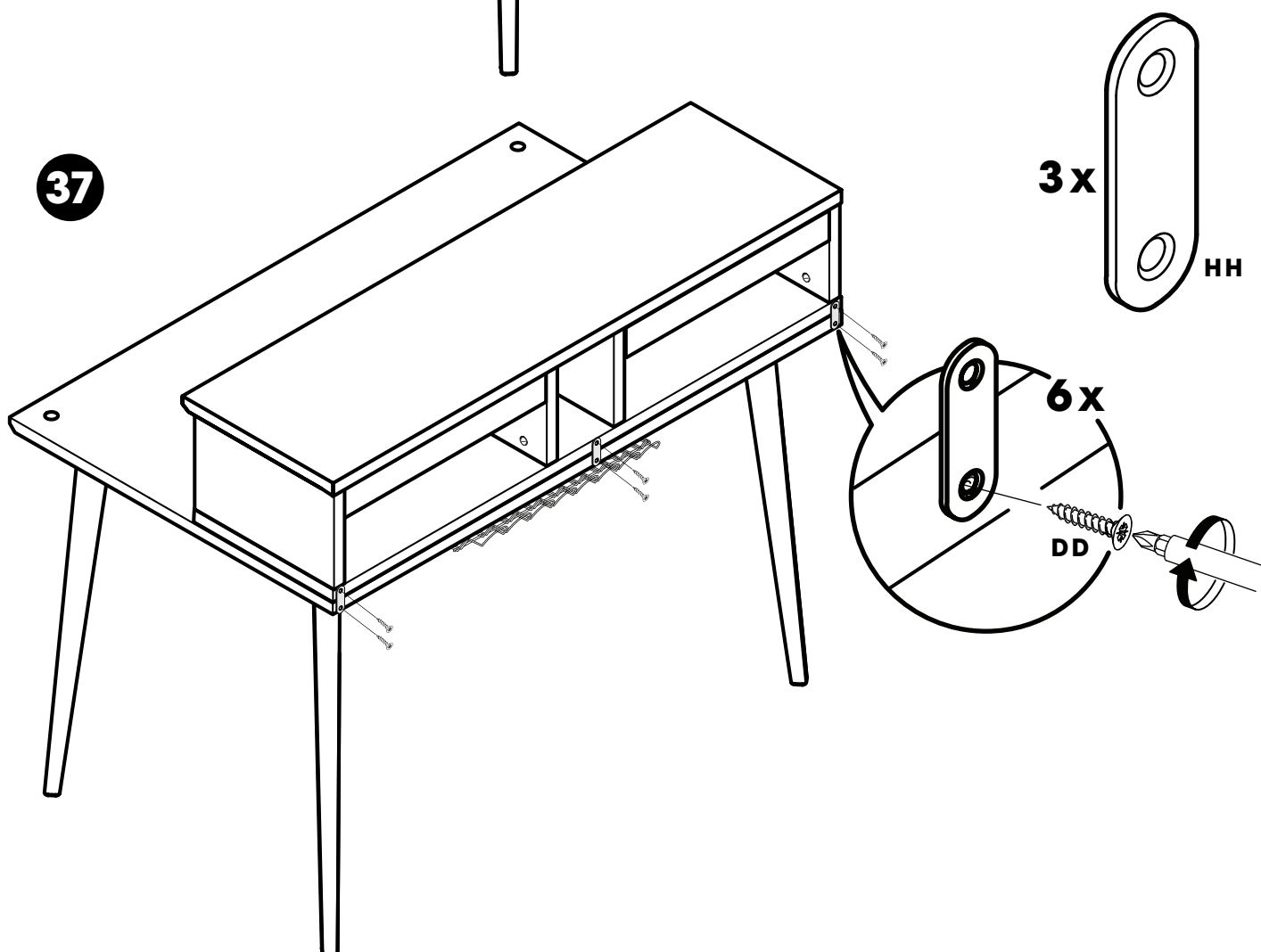

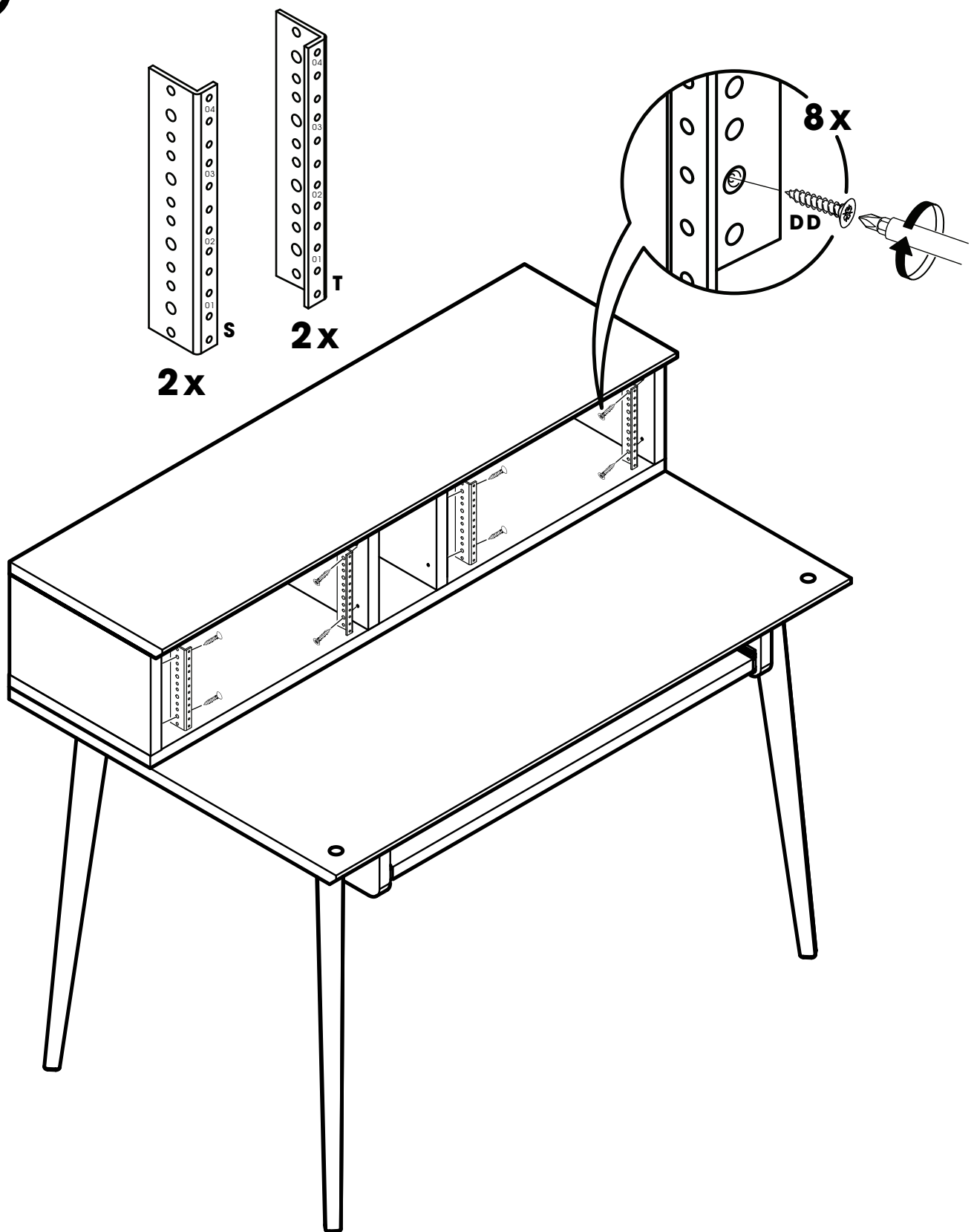

39

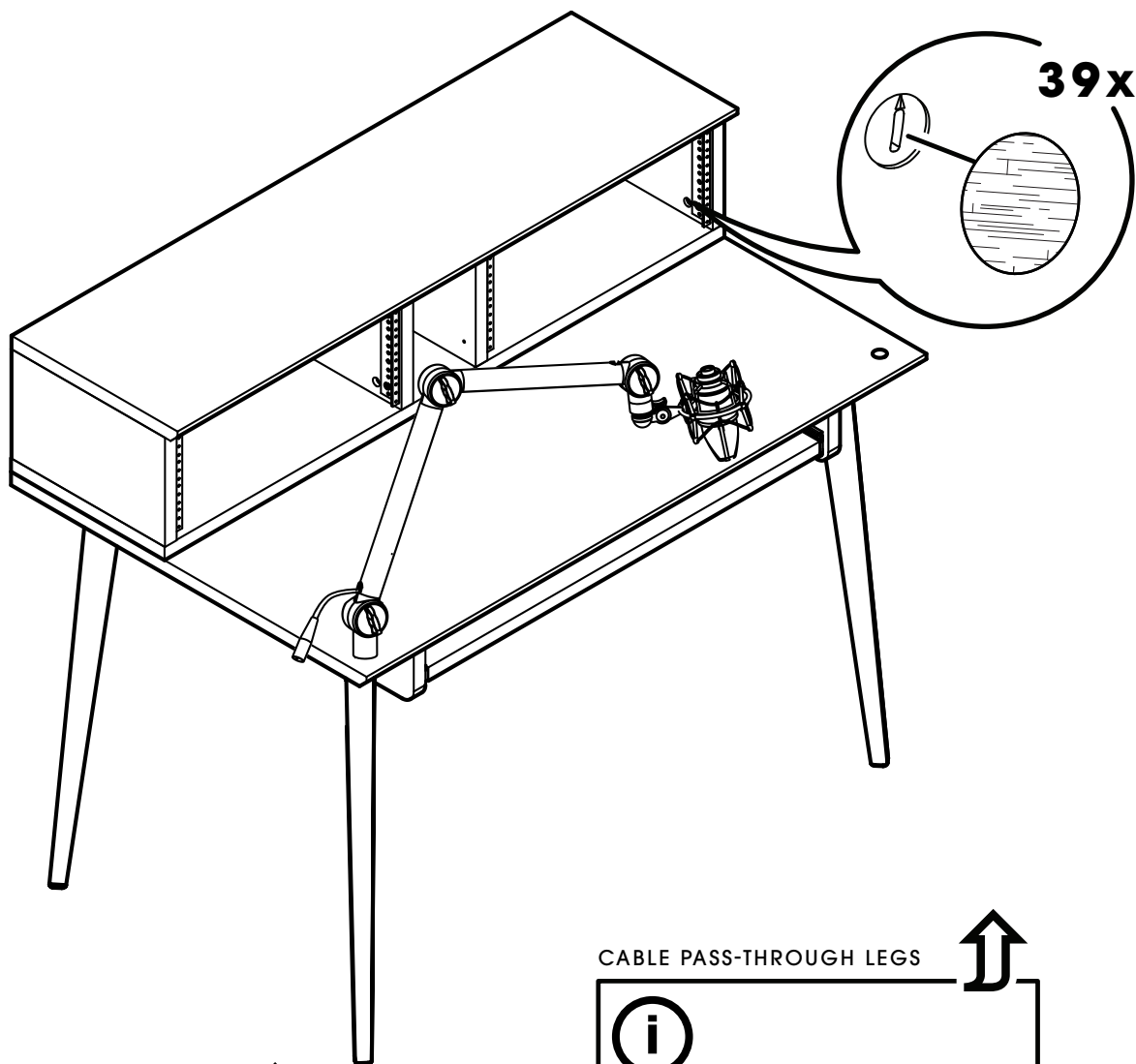

BOOM ARMS SOLD SEPARATELY

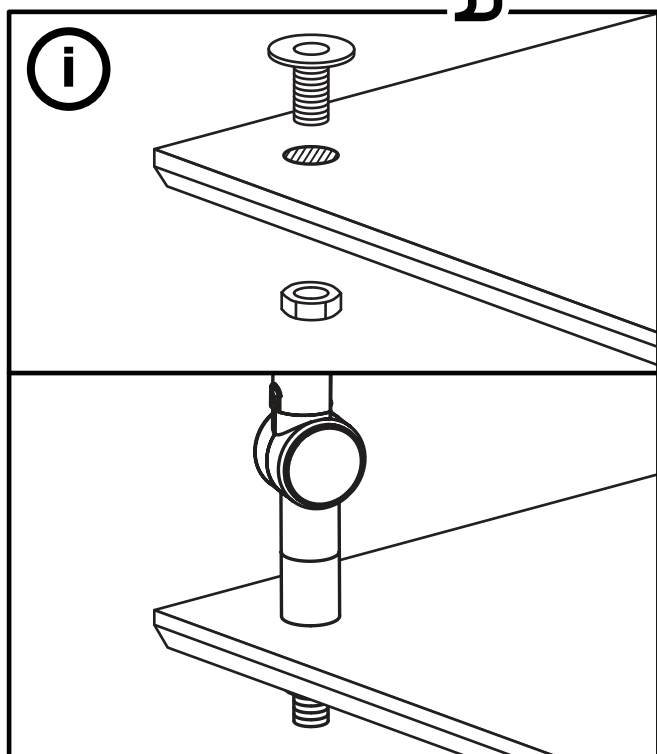

CABLE PASS-THROUGH LEGS

